

PEJZAŽNA ARHITEKTURA

ANALIZA I PLANIRANJE LOKACIJE: uređenje i korišćenje otvorenih prostora

Jelena Živković

PROCES planiranja lokacije javnog otvorenog prostora

Postojeće stanje

- **Položaj lokacije u gradu**
- **Karakteristike lokacije**
- **Karakteristike okruženja**

Potencijali i ograničenja za razvoj:

- **sinteza informacija o vrednostima i problemima,**
- **identifikacija mogućih obrazaca razvoja**

Strategije razvoja u skladu sa:

- **Unapređenje kvaliteta življenja ljudi**
- **Unapređenje ekoloških kvaliteta urbane sredine**

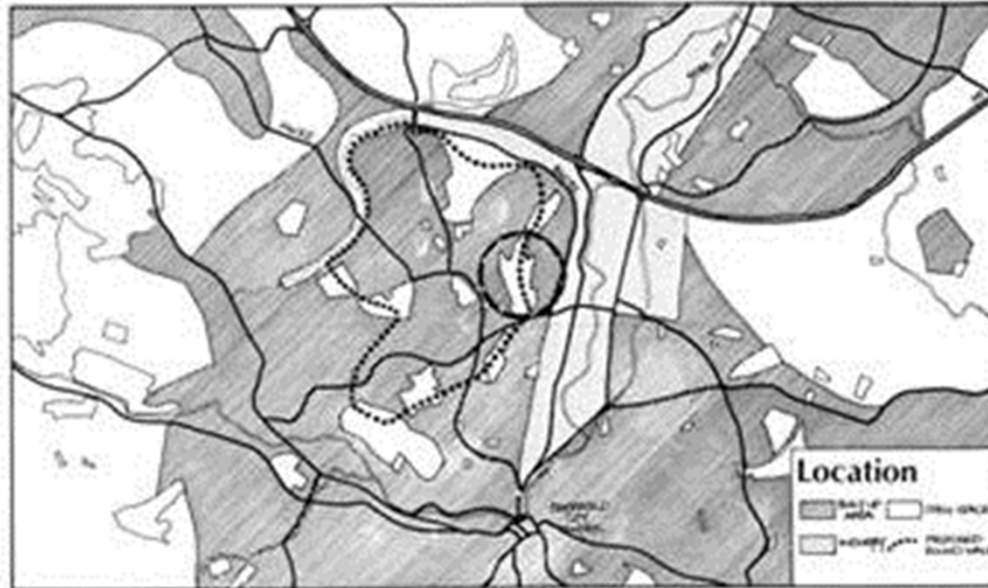

0 10 20 30 40

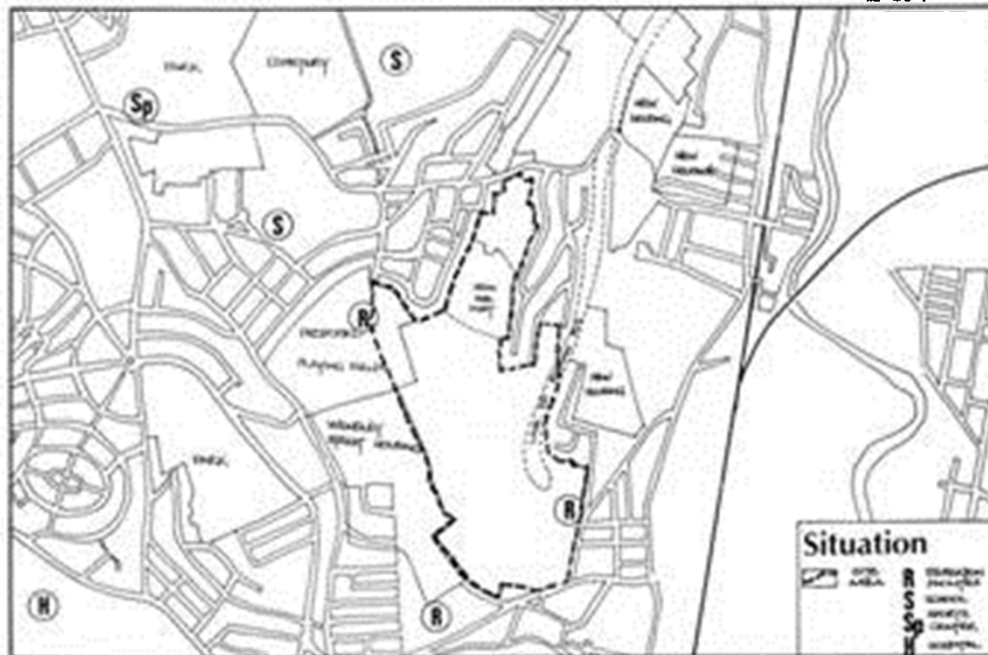

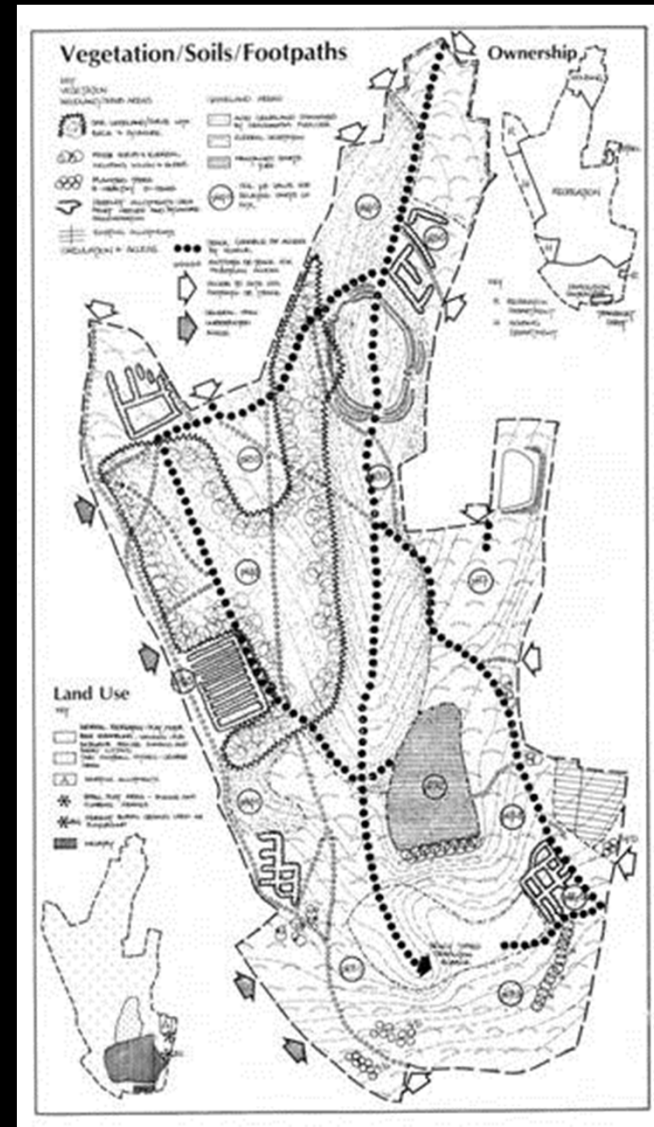
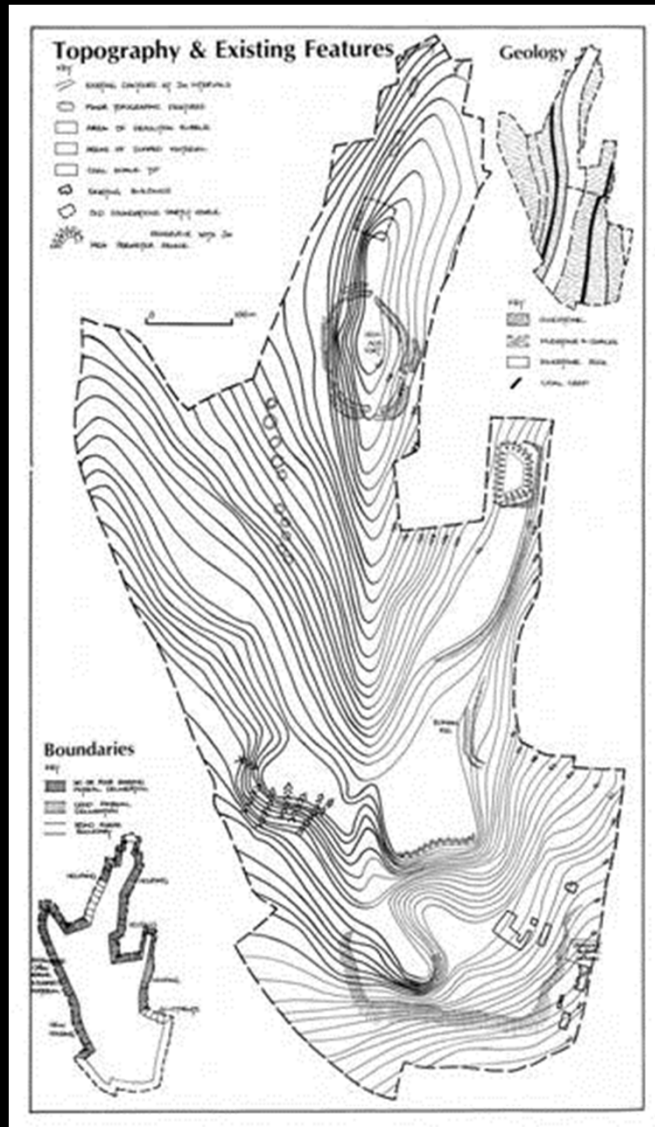

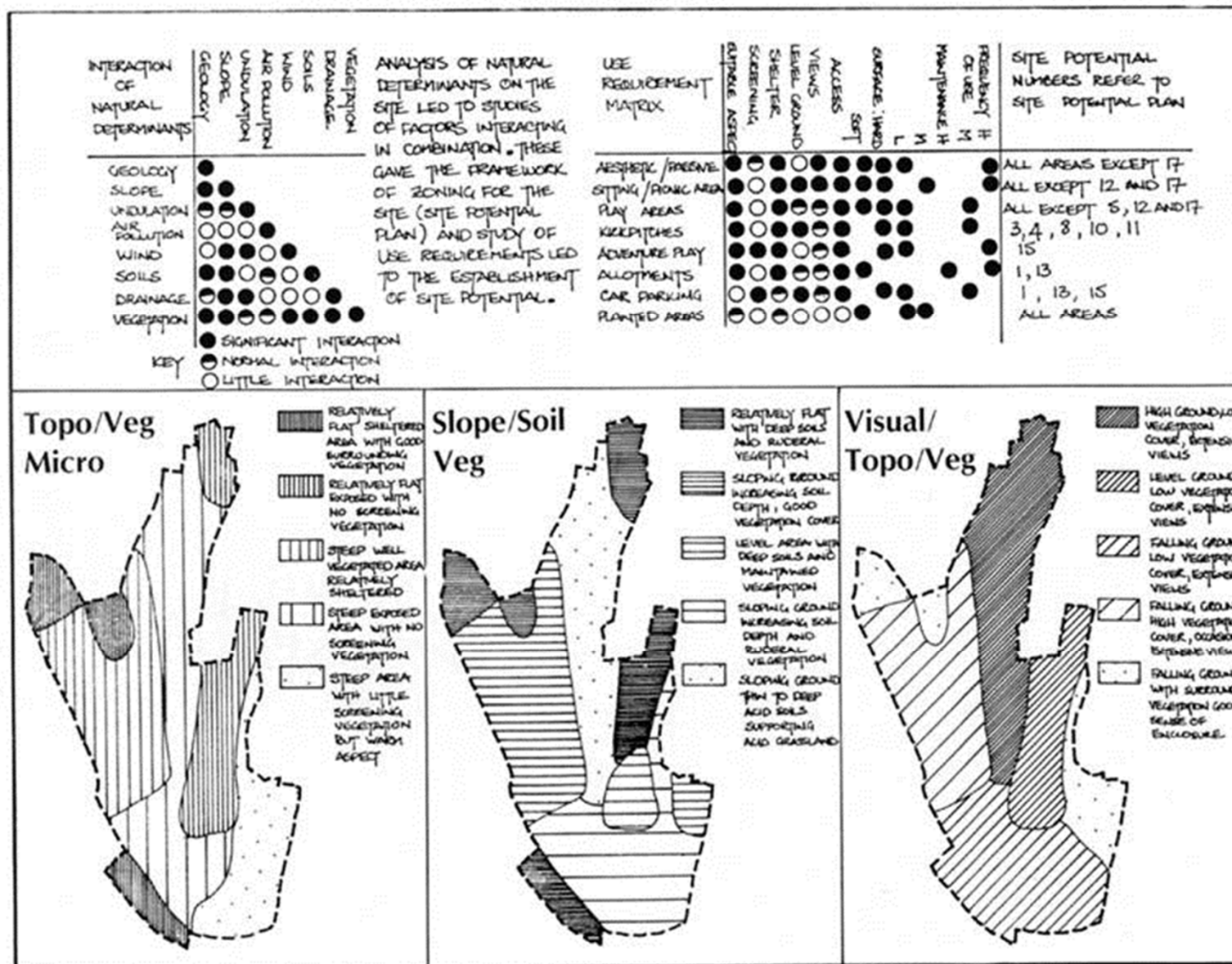

Section cc

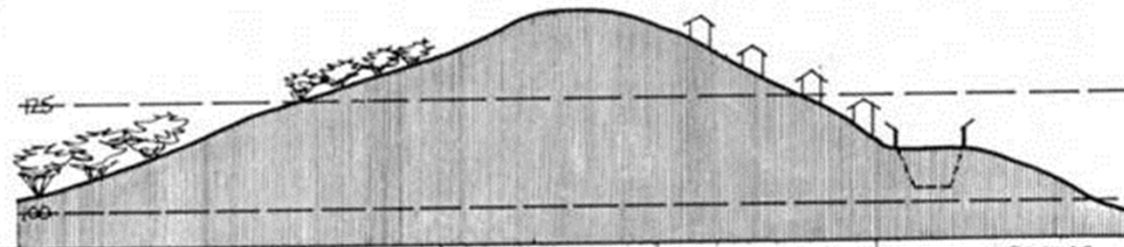

Problems

<p>CLEARING</p> <p>WOOD - MULTITEMPERED OAK SCRUB</p> <p>GRADATION IN HEIGHT TO EXPOSED SUMMIT</p>	<p>LACK OF PHYSICAL BOUNDARY BETWEEN RIDGE AND ADJACENT HOUSING - DUMPING</p>	<p>HOUSING - 1954 to 1972</p> <p>MASSIVE UNDERBUILDING</p> <p>GREAT VISUAL INTRUSION</p> <p>SOME DISTANCE FROM SITE</p>	<p>RESERVOIR -</p> <p>VISUAL INTRUSION AND SOME DANGER</p>
--	---	---	--

Section dd

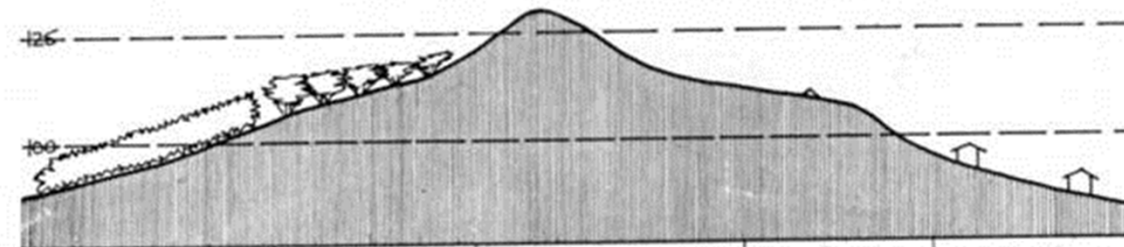

Problems

<p>DERELICT OVERGROWN ALLOTMENTS - DUMPING</p>	<p>WOOD - GREATLY STUNTED NEAR EXPOSED SUMMIT</p>	<p>EXPOSED RIDGE WALK BUT STRONG VISUAL IMPACT SOME DISTANCE FROM SITE</p>	<p>ROMAN RIG - NO DELINEATION</p> <p>DUMPING PROBLEM</p>	<p>HOUSING - VERY POOR PHYSICAL BOUNDARY WITH SITE AND LACK OF PRIVACY</p>
--	---	--	--	--

Section ee

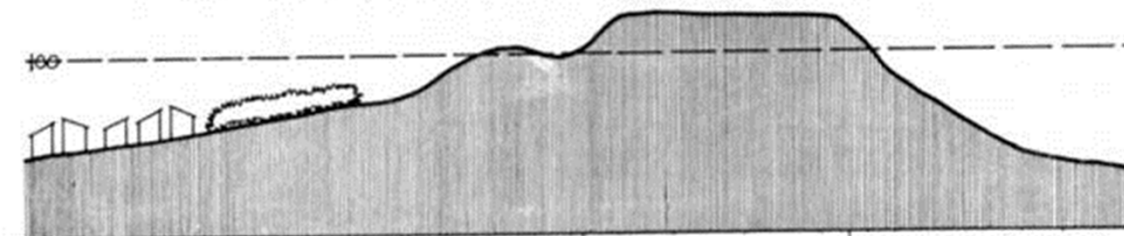

Problems

<p>WINDLEY SPENT HOUSING - STARTED 1974 - LACK OF EQUIPMENT</p>	<p>DERELICT OVERGROWN ALLOTMENTS - DUMPING PROBLEM</p>	<p>OLD ORAL SHALE TIP - COMPACTED ON TOP, RIDGES DEEPLY CALLED, MOTOR CYCLE SCRAMBLING</p>	<p>FOOTBALL PITCHES - EXPOSED BADLY DRAINED, LARGE CRACKS ON SOUTHERN EDGE - PRIVACY PROBLEM</p>	<p>GROUND FALLS FAIRLY STEEPLY AWAY DESPITE ASPECT FURTHER EXPOSED AWKWARD ACCESS TO EXISTING FOOTBALL PITCHES</p>
---	--	--	--	--

Policy

NATURAL ENVIRONMENT

1. GENERAL POLICY OF MAXIMISING EXISTING GROUND FORM AND VEGETATION POTENTIAL.
2. MAINTAIN CERTAIN LOW KEY RUGGEDNESS OF SITE (IT PROVIDE SCREENING TO AMELIORATE UNFAVOURABLE MICROCLIMATE, EXTENSIVE PLANTING PROGRAMME, EXTENSION OF WINGOBANK WOOD VIA STRUCTURE PLANTING OF MIXED WOODLAND.
3. MINIMUM OF EARTH MOVING - AREA AROUND ROMAN RIG AND WINGOBANK IRON AGE HILL FORT PROTECTED.

VISUAL POLICY

1. MAIN AIM TO MAXIMISE VIEWS AFFORDED FROM THE SITE OUT.
2. VIEWS INTO SITE VERY IMPORTANT - RIDGE AREA AND FORT LEFT UNPLANTED
3. VEGETATION TO BE ESTABLISHED FOCUSING VIEW AND CREATING INTERESTING MASS / VOID RELATIONSHIPS.

RECREATION POLICY

1. ESTABLISH HIERARCHY OF RECREATIONAL FACILITY
 - a. SMALL INFORMAL SPACES FOR SITTING AND PLAY AREAS ON EDGE OF THE SITE / LOCAL INTEREST.
 - b. KICKABOUT AND PLAYGROUND FACILITY - LOCATED FURTHER FROM IMMEDIATE HOUSING.
 - c. ADVENTURE PLAYGROUND AND LARGE PLAY SPACE - LOCATED IN OLD QUARRY SITE / DISTRICT INTEREST.
2. PROVISION ALSO FOR ARCHAEOLOGICAL AND WOODLAND TRAIL WITH ASSOCIATED PICNIC, VIEWPOINTS AND CAR PARK FACILITIES.

ACCESS AND CIRCULATION

1. THREE MAIN ENTRANCES PROPOSED FOR ACCESS BASED ON THE AXES OF THE ARCHAEOLOGICAL AND WOODLAND TRAILS.
2. VEHICULAR ACCESS TO SITE POSSIBLE ONLY FROM NORTH ENTRANCE, VEHICULAR ACCESS RESTRICTED EXCEPT FOR MAINTENANCE

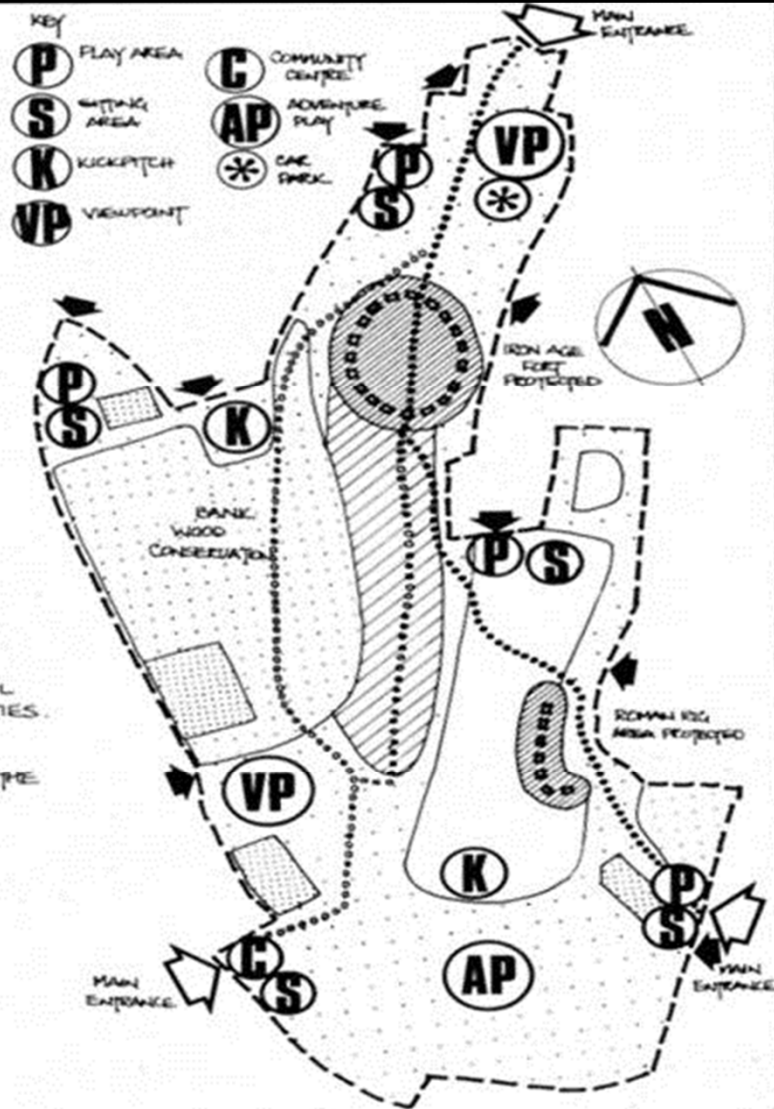

Proces planiranja lokacije

prema: *Environmental Planning for Site Development*,
Ann R. Beer and Catherine Higgins

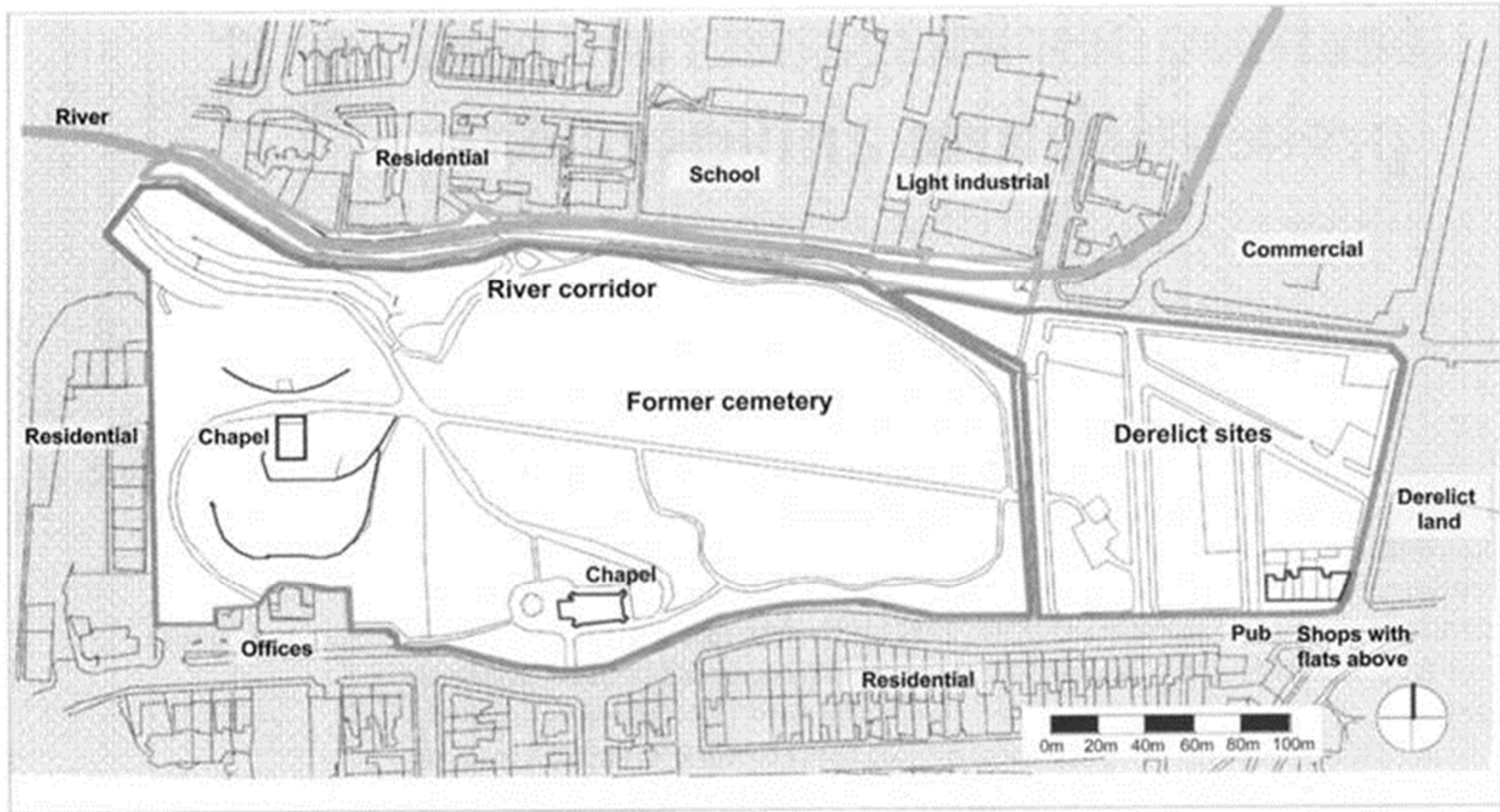

Figure 15.1 The project area.

Postojeće stanje

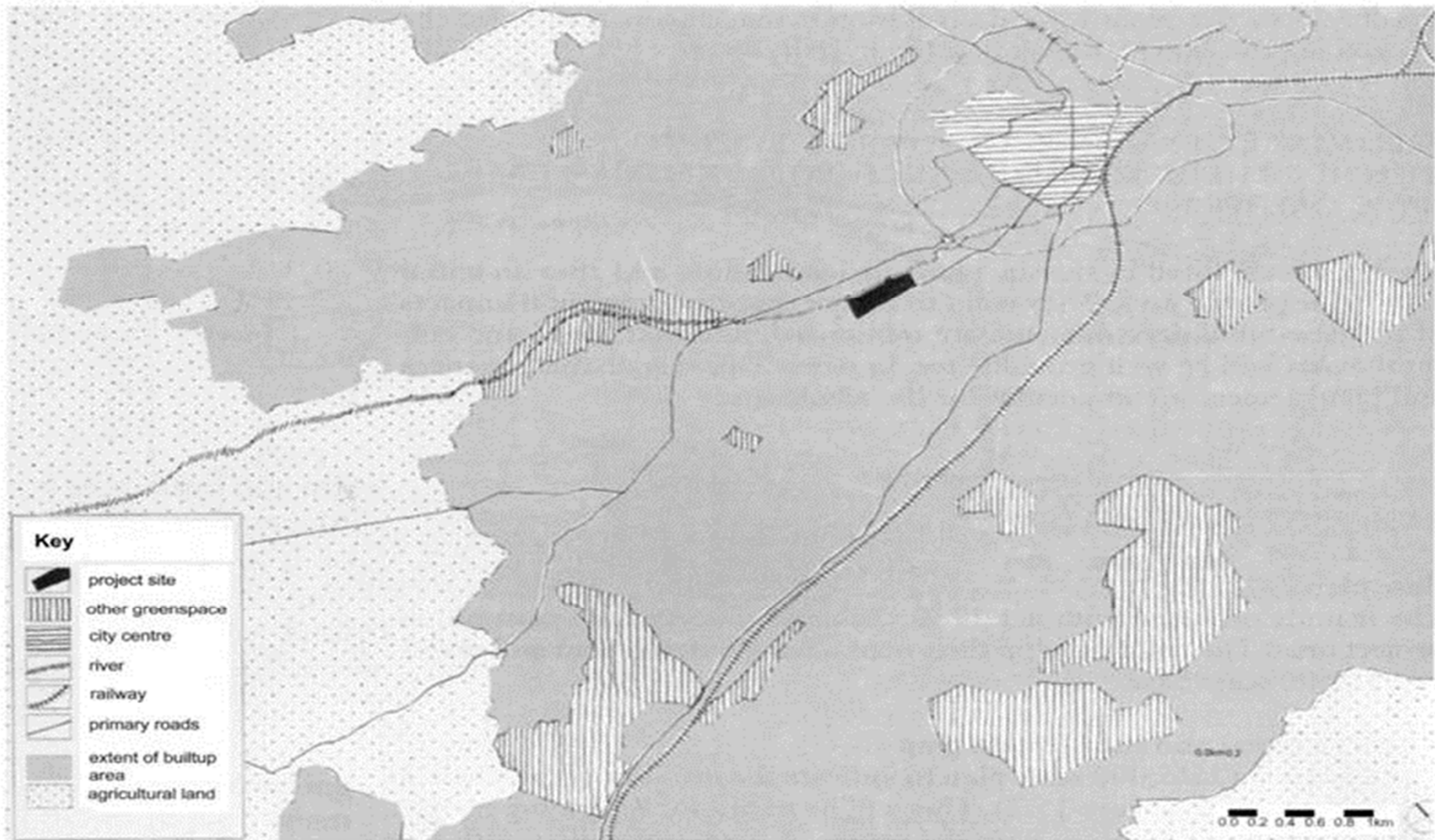

Figure 15.2 District context and site location plan.

Položaj lokacije u gradu



Figure 15.4 Site topography – contour plan.

Topografija lokacije

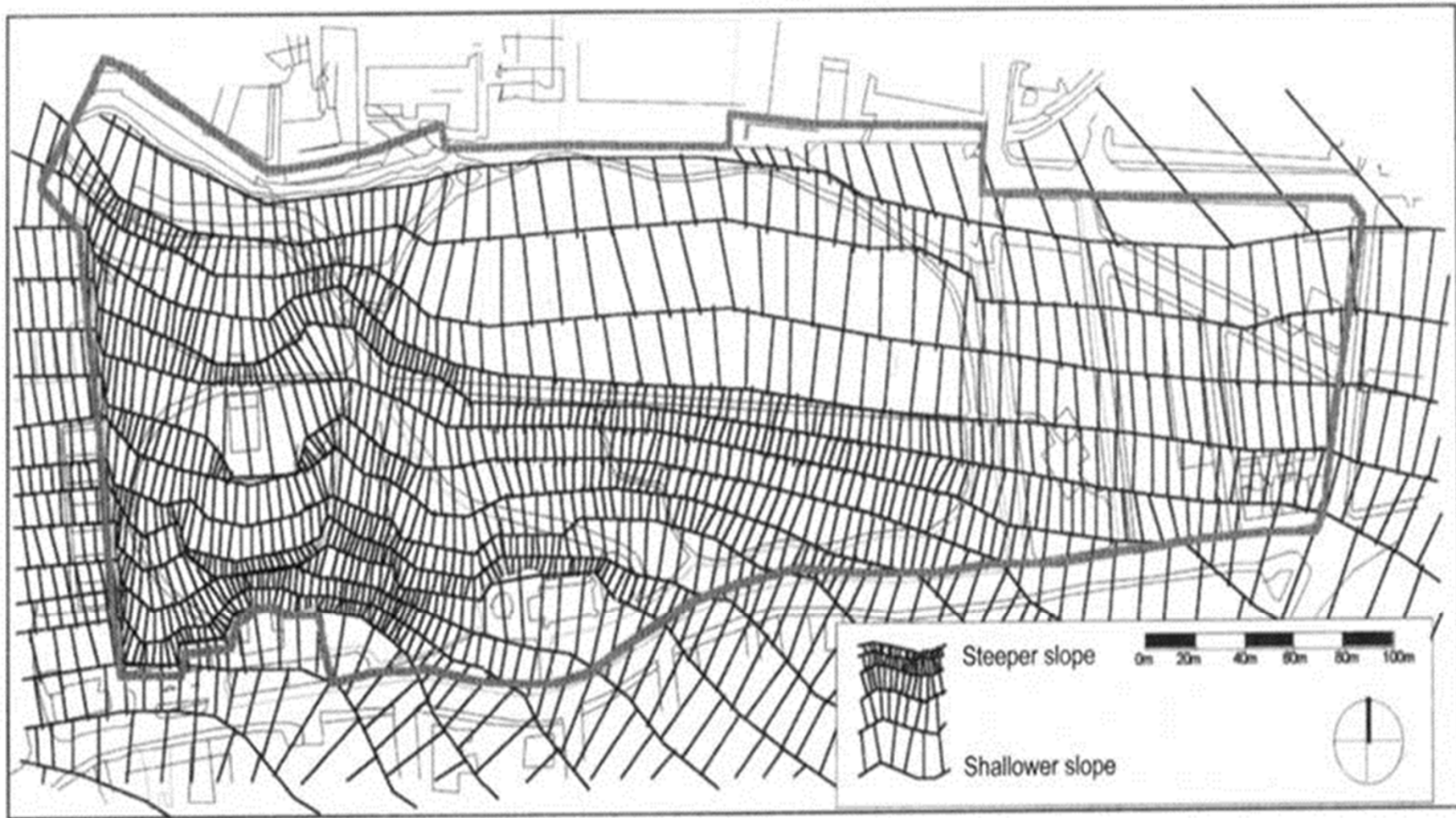

Figure 15.5 Site topography – slope analysis.

Analiza nagiba terena

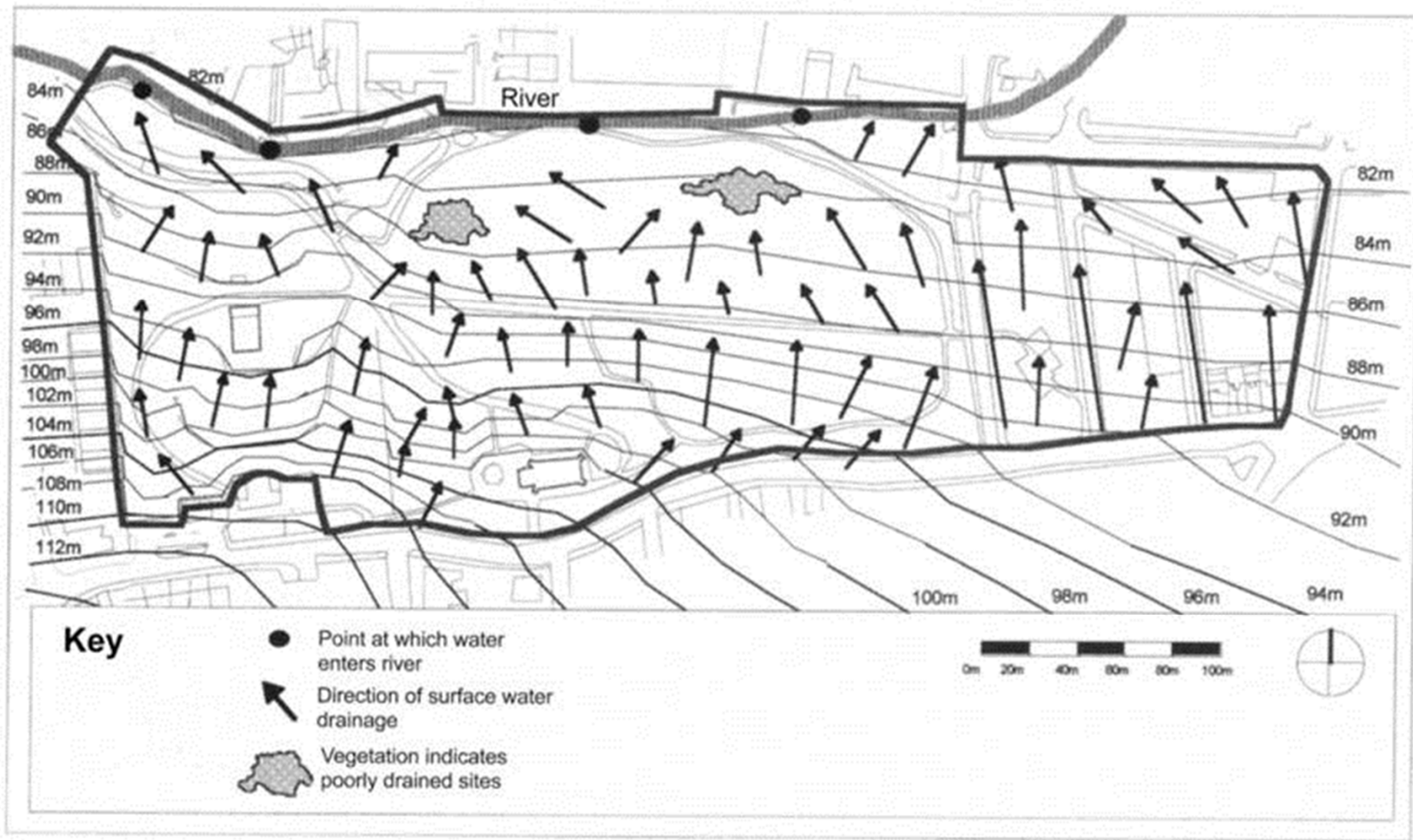

Figure 15.3 Site water and drainage related to topography.

Voda i drenaža na lokaciji u relaciji sa topografijom

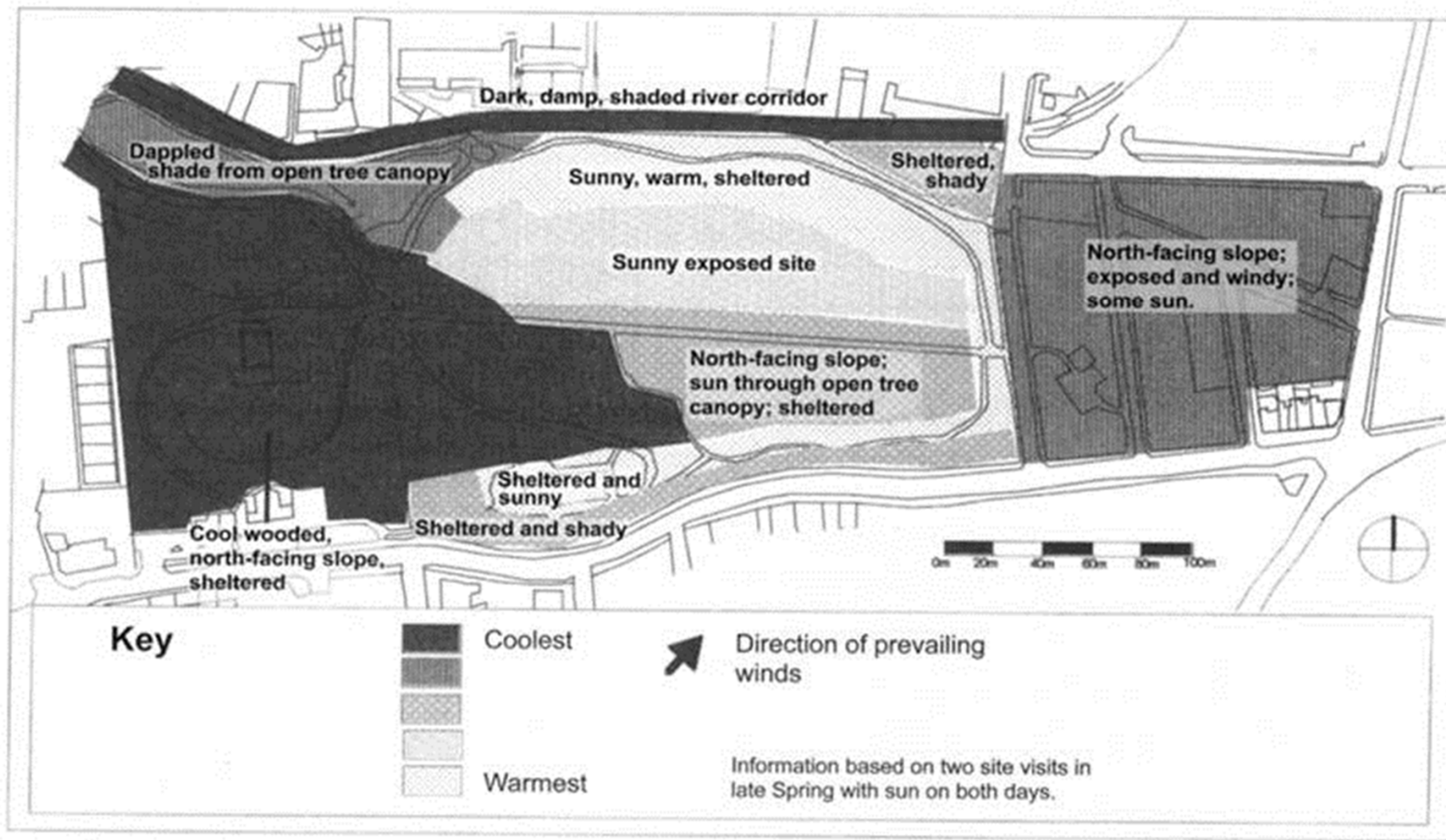

Figure 15.6 Plan summarizing the key microclimatic features of the area.

Sintezni plan mikroklimatskih karakteristika oblasti: orijentacija, osunčanost, izloženost vetru

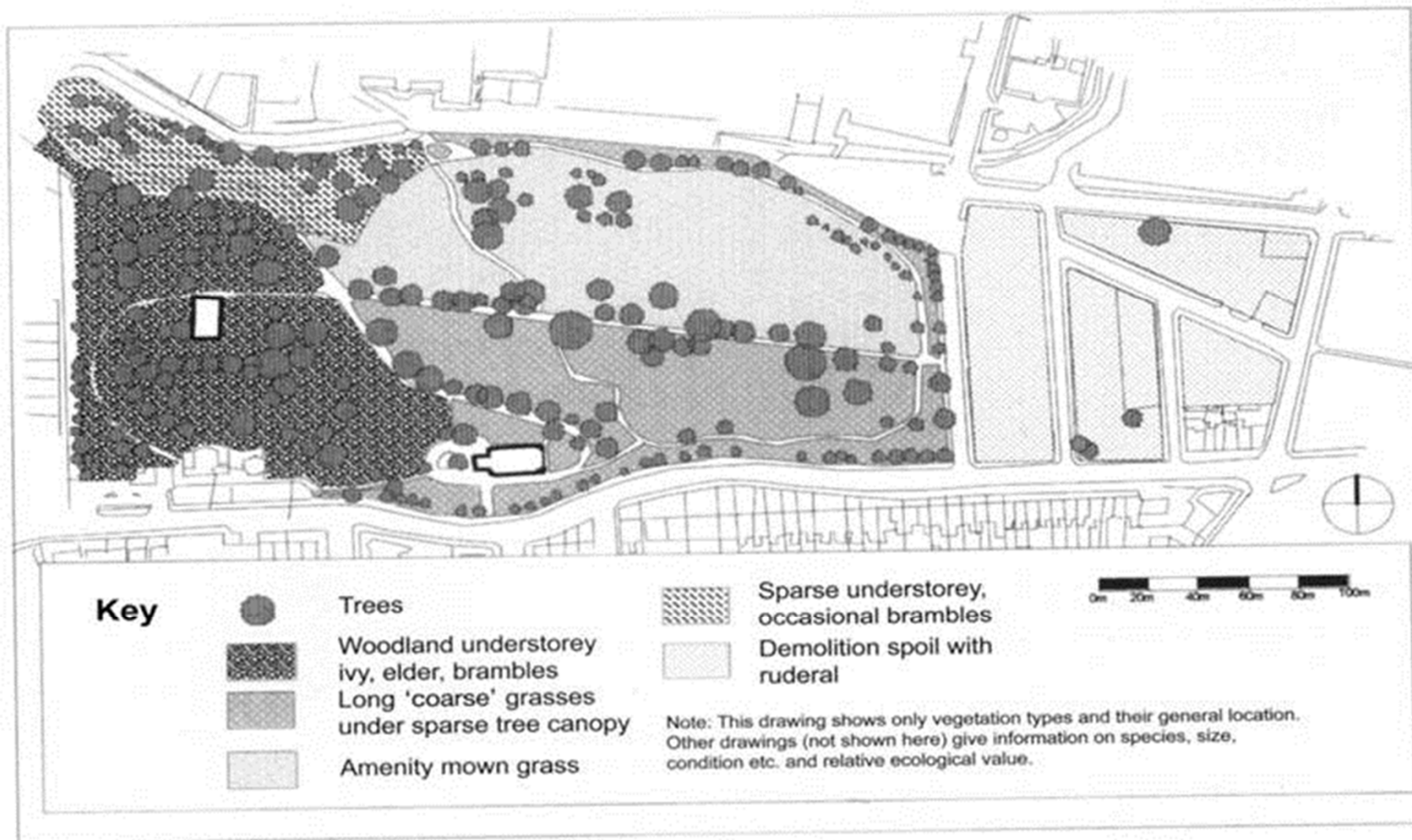

Figure 15.7 Plan indicating the main types of vegetation and their location.

Osnovni tipovi vegetacije i njihova lokacija

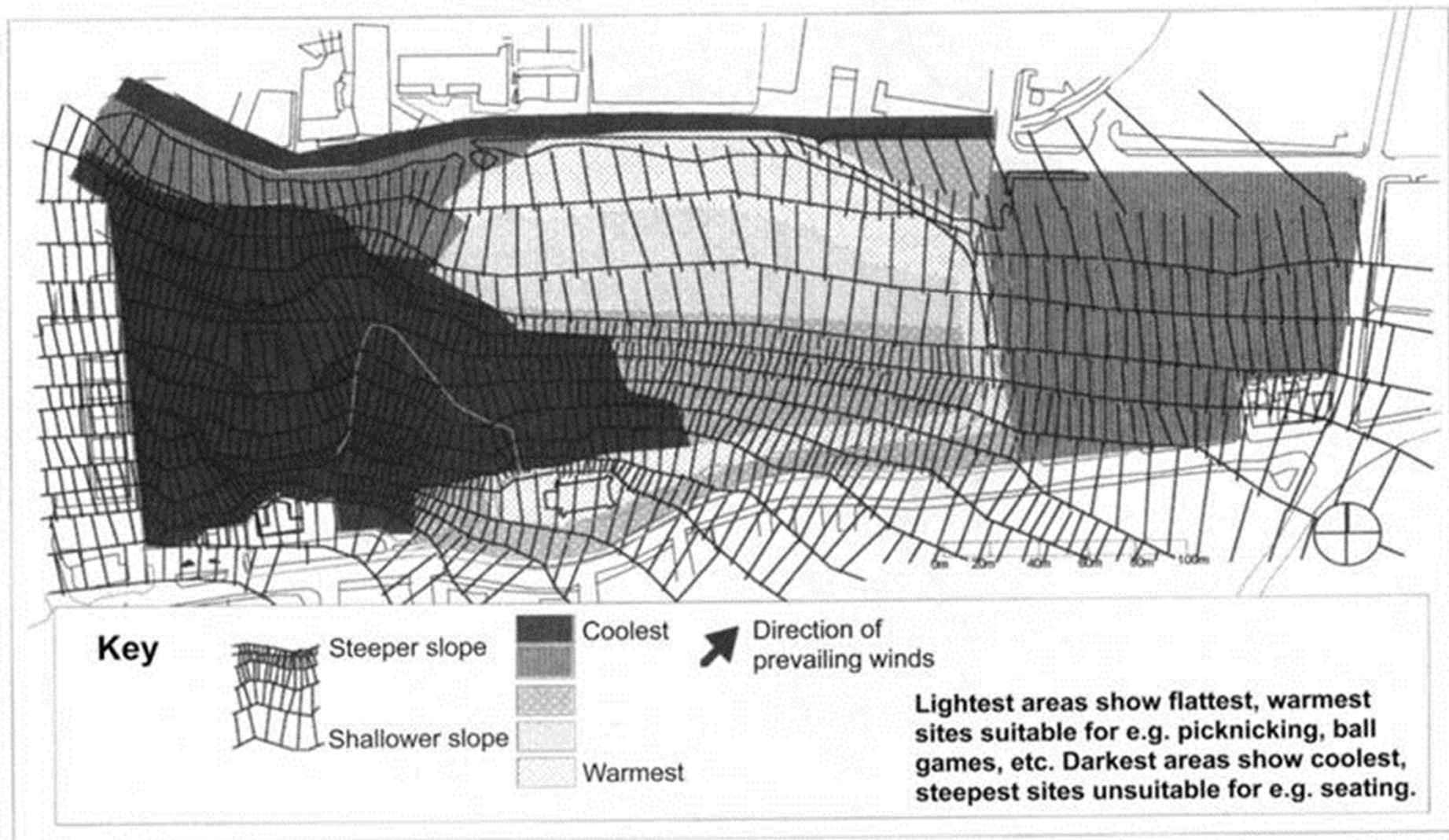

Figure 16.2 Sieved map, layering microclimate information with slope analysis.

Sinteza karta prirodnih uslova na lokaciji

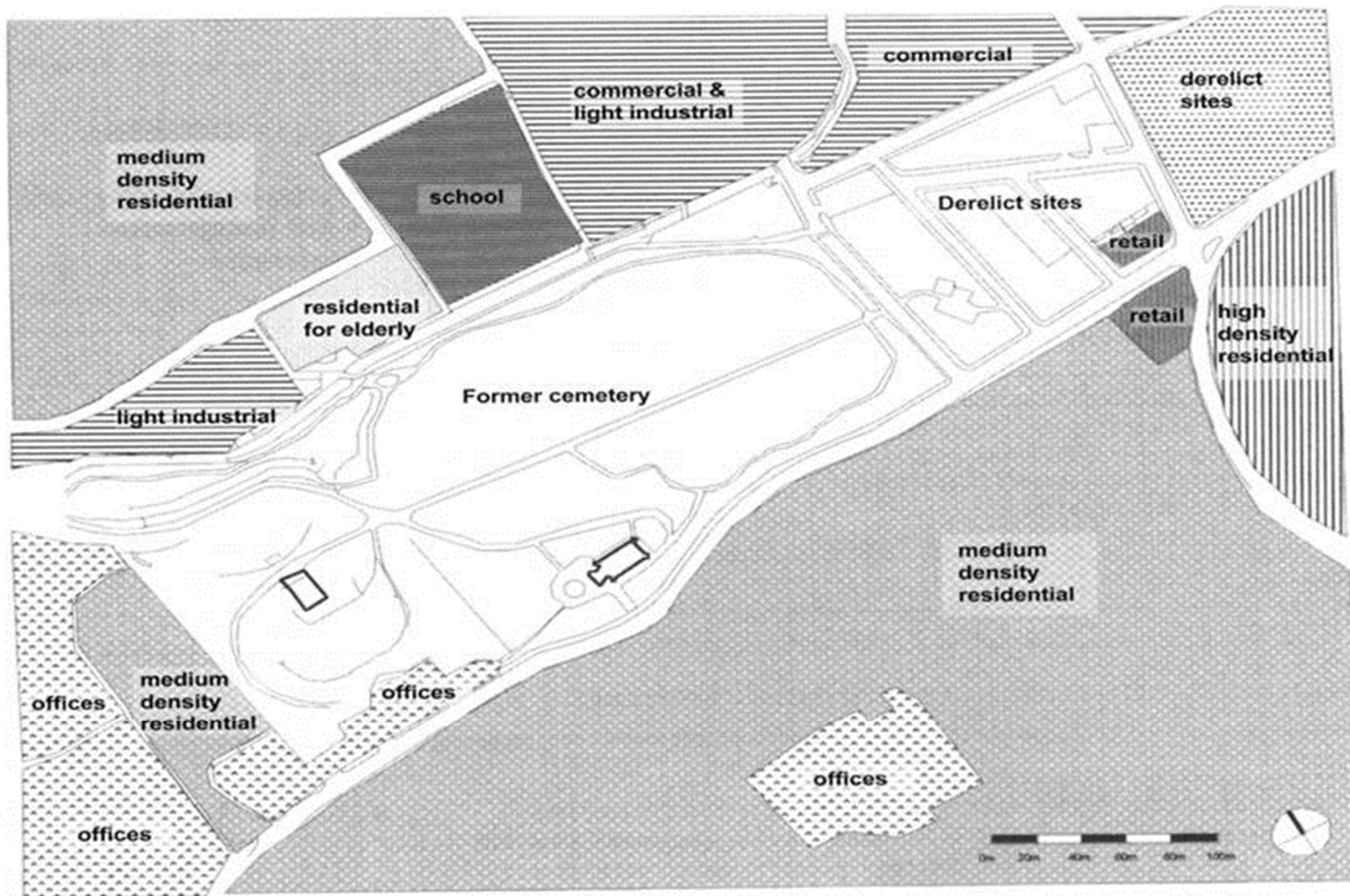

Figure 15.9 Land uses surrounding the site (figure shows only part of the original drawing).

Namena prostora u neposrednom okruženju

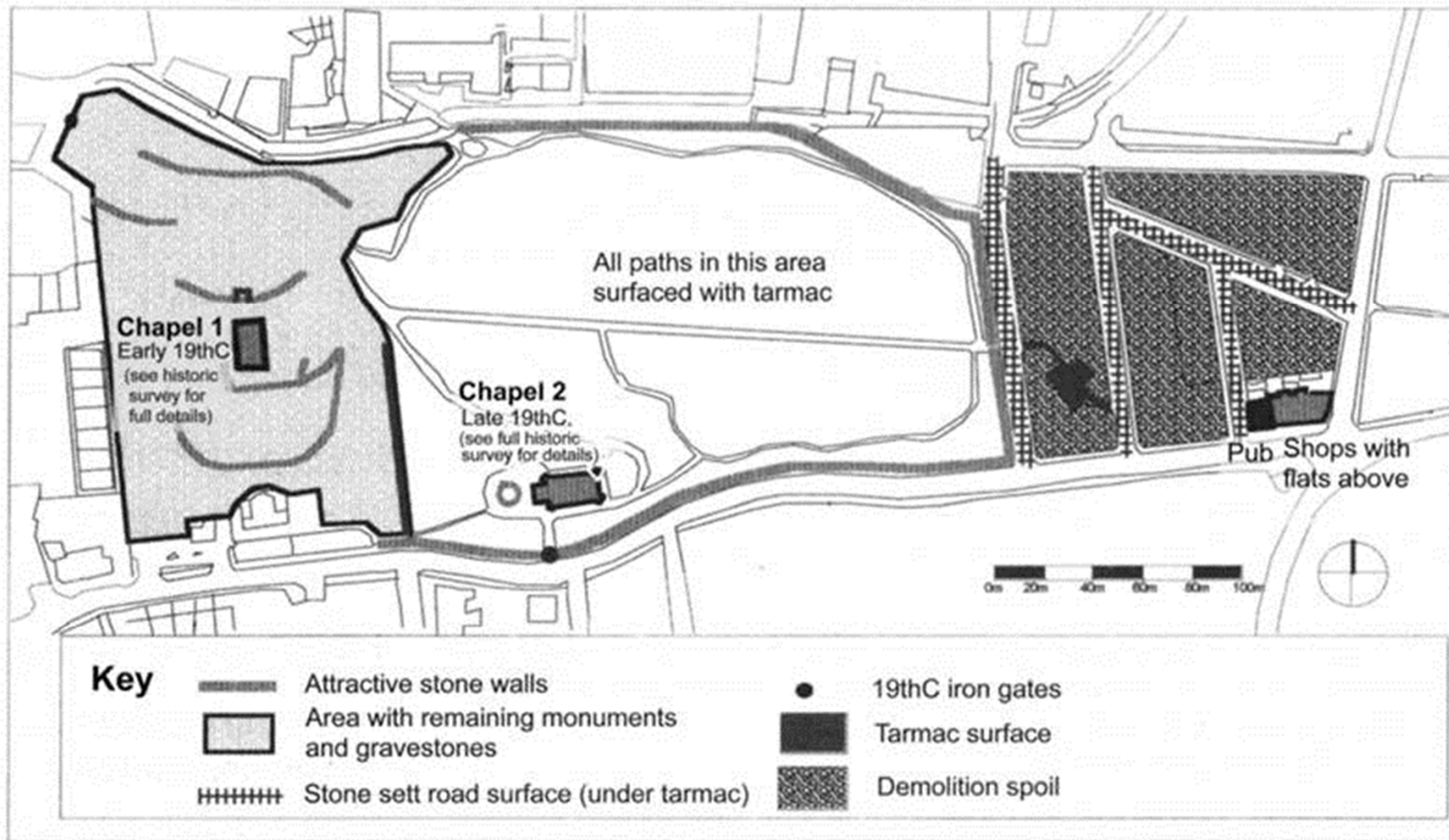

Figure 15.8 Plan indicating locations of site structures.

Izgrađene fizičke strukture na lokaciji

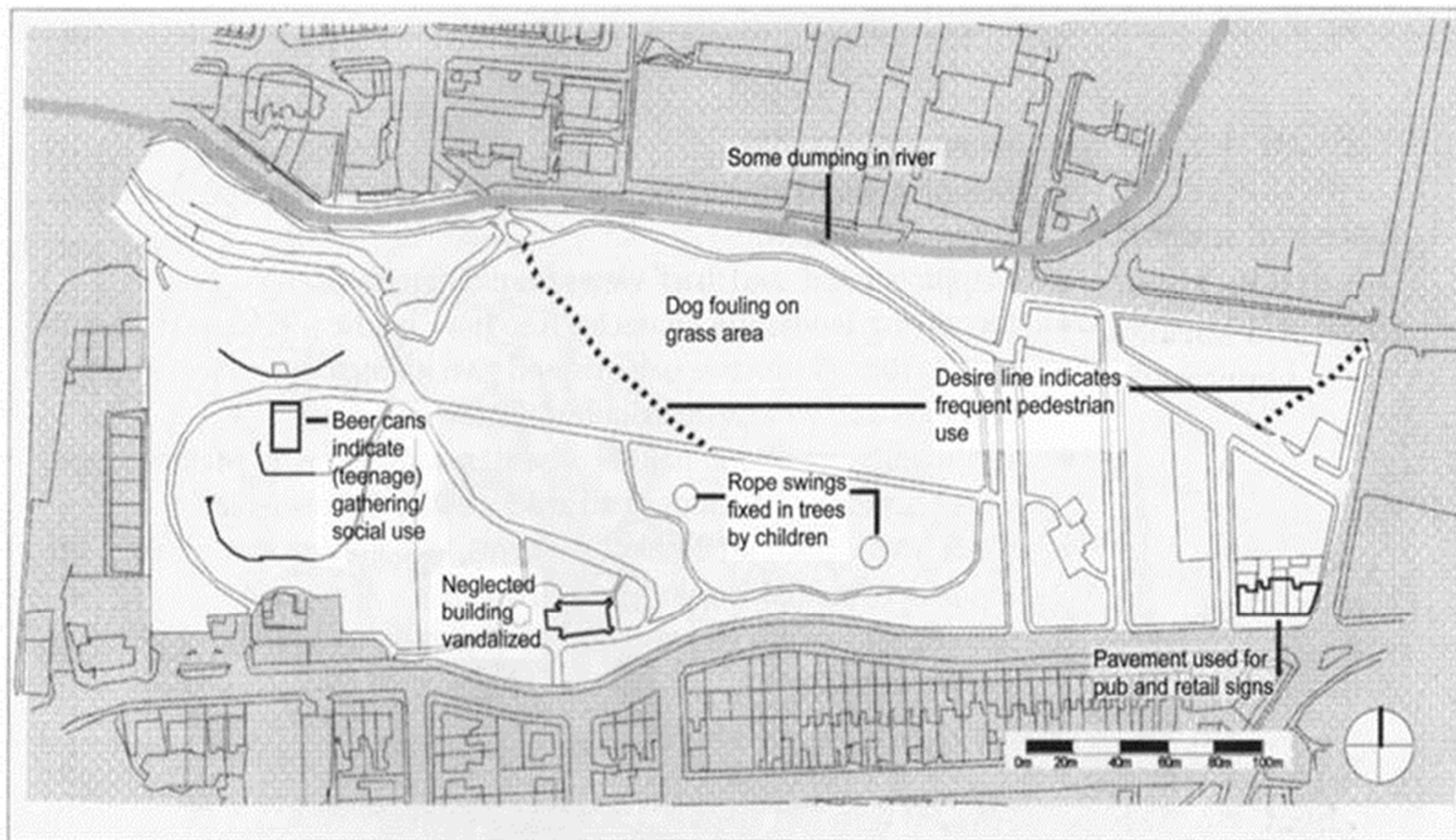

Figure 15.10 Plan recording traces of current activities.

Identifikacija aktivnosti na lokaciji

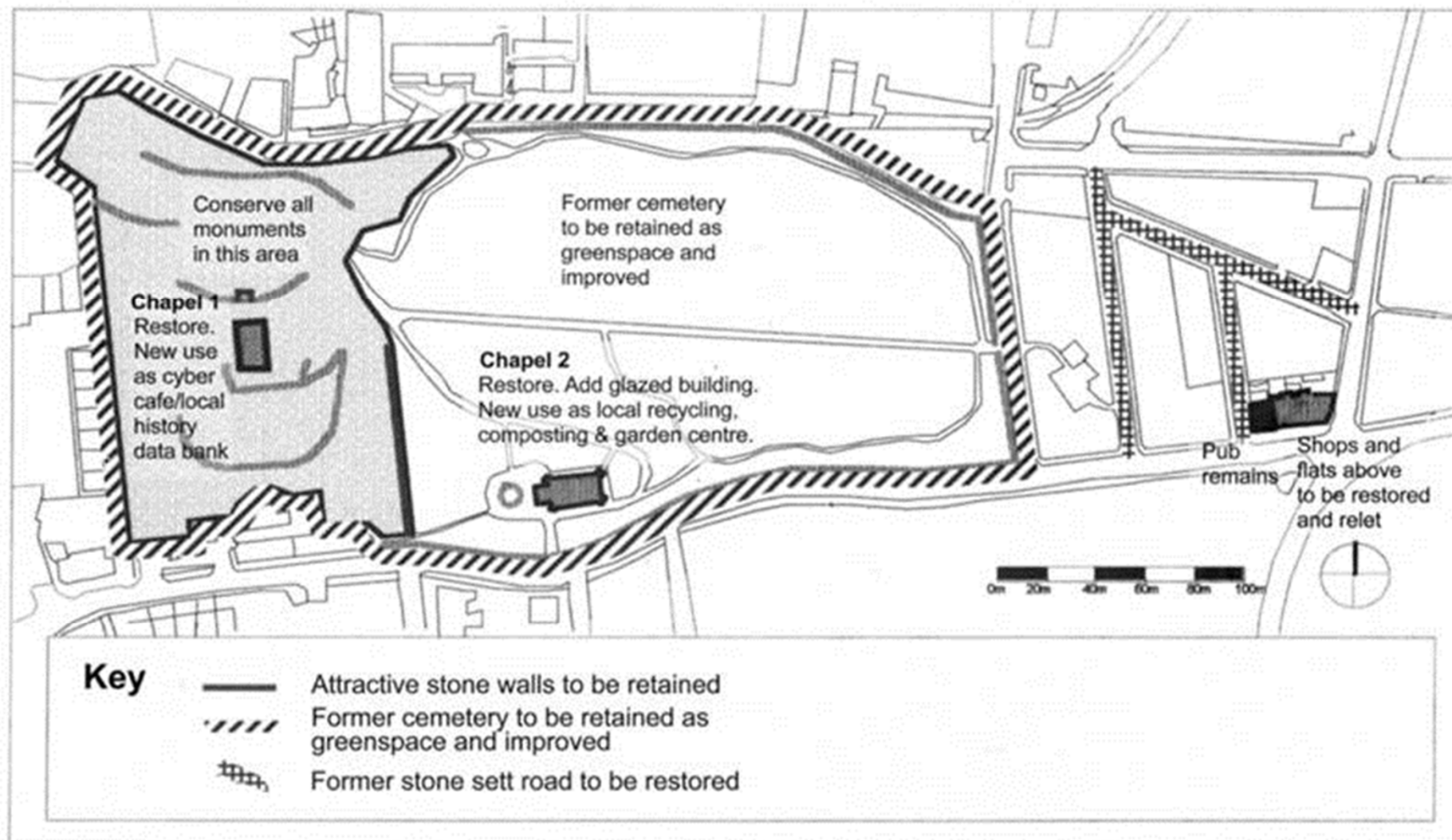

Figure 17.1 Land uses and structures to be conserved.

Zaštita i unapređenje prirodnih i stvorenih vrednosti na lokaciji

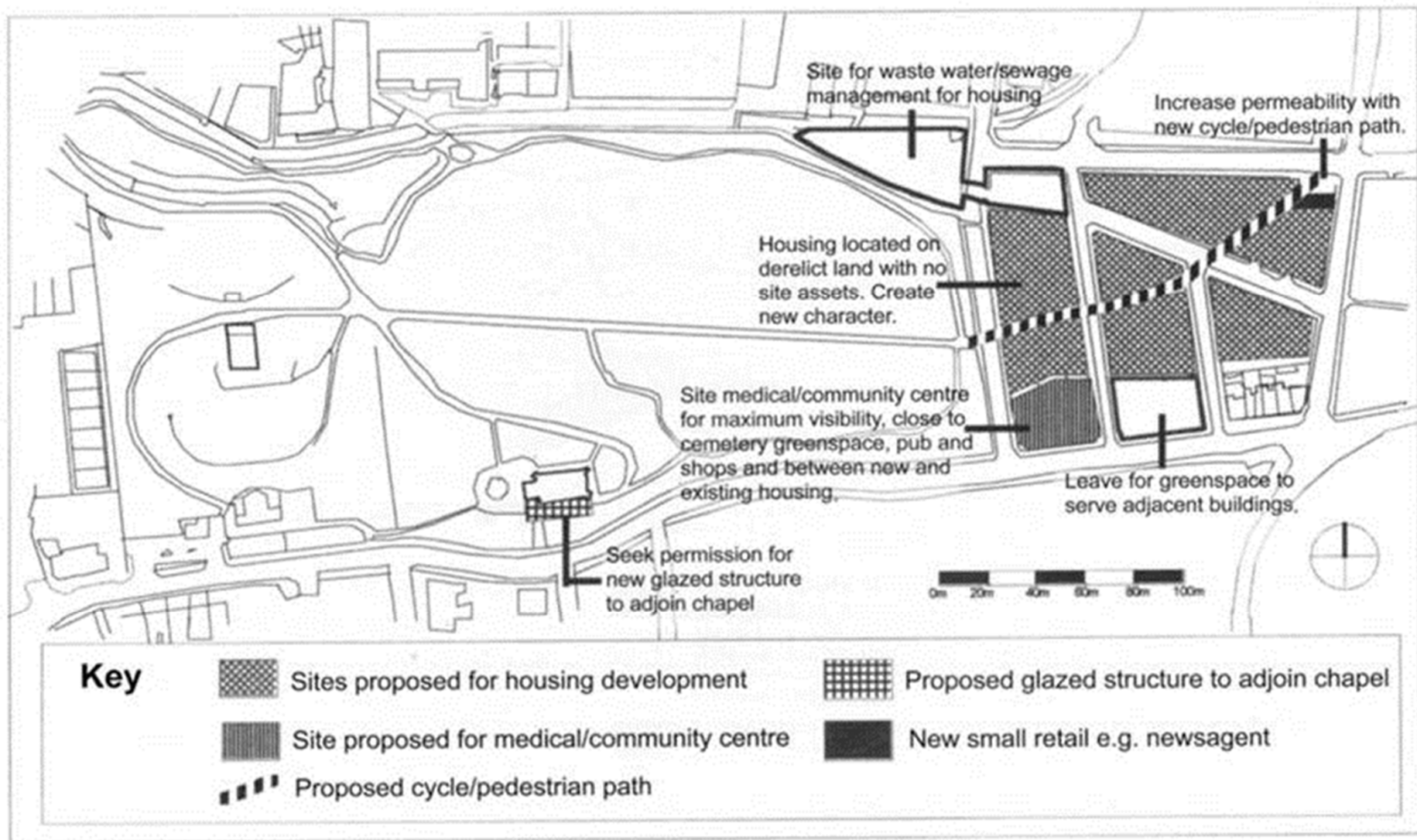

Figure 17.2 Locations for newly built development.

Lokacije novoplaniranih sadržaja i fizičkih struktura

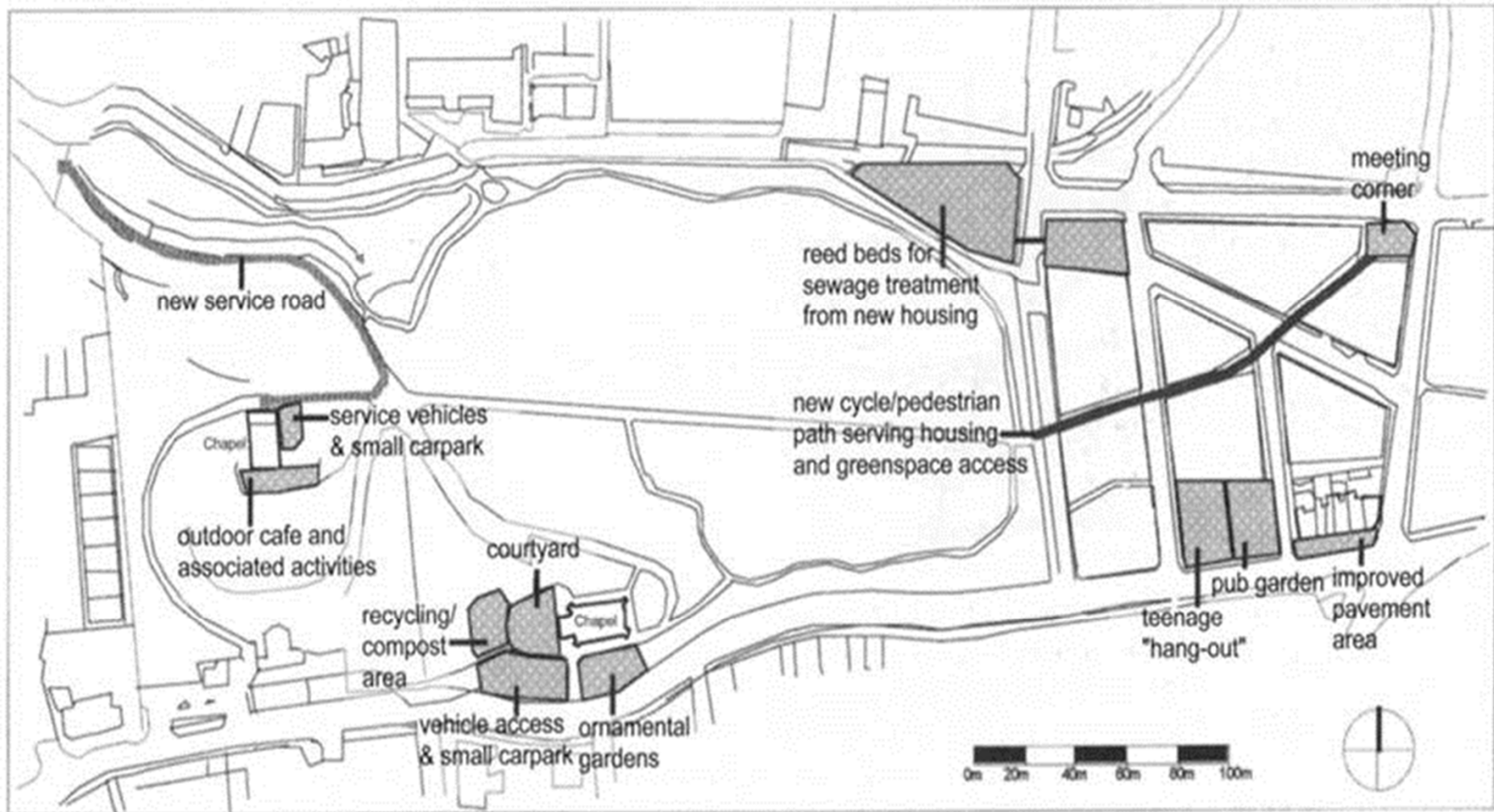

Figure 17.3 Proposed land uses complementing building uses.

Predlog komplementarnog korišćenja otvorenog prostora

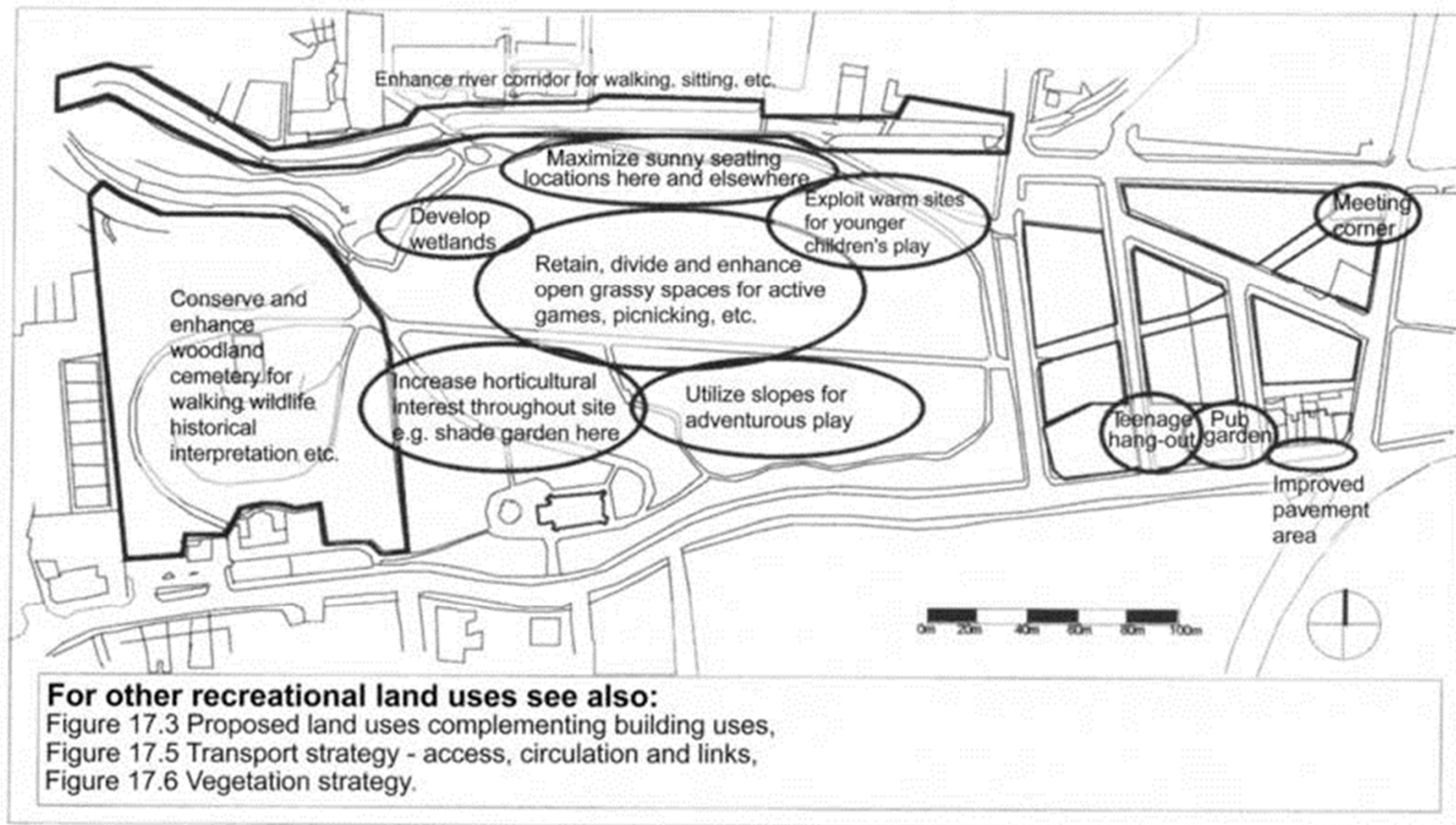

Figure 17.4 Proposed recreational land uses.

Predlog korišćenja prostora za rekreaciju

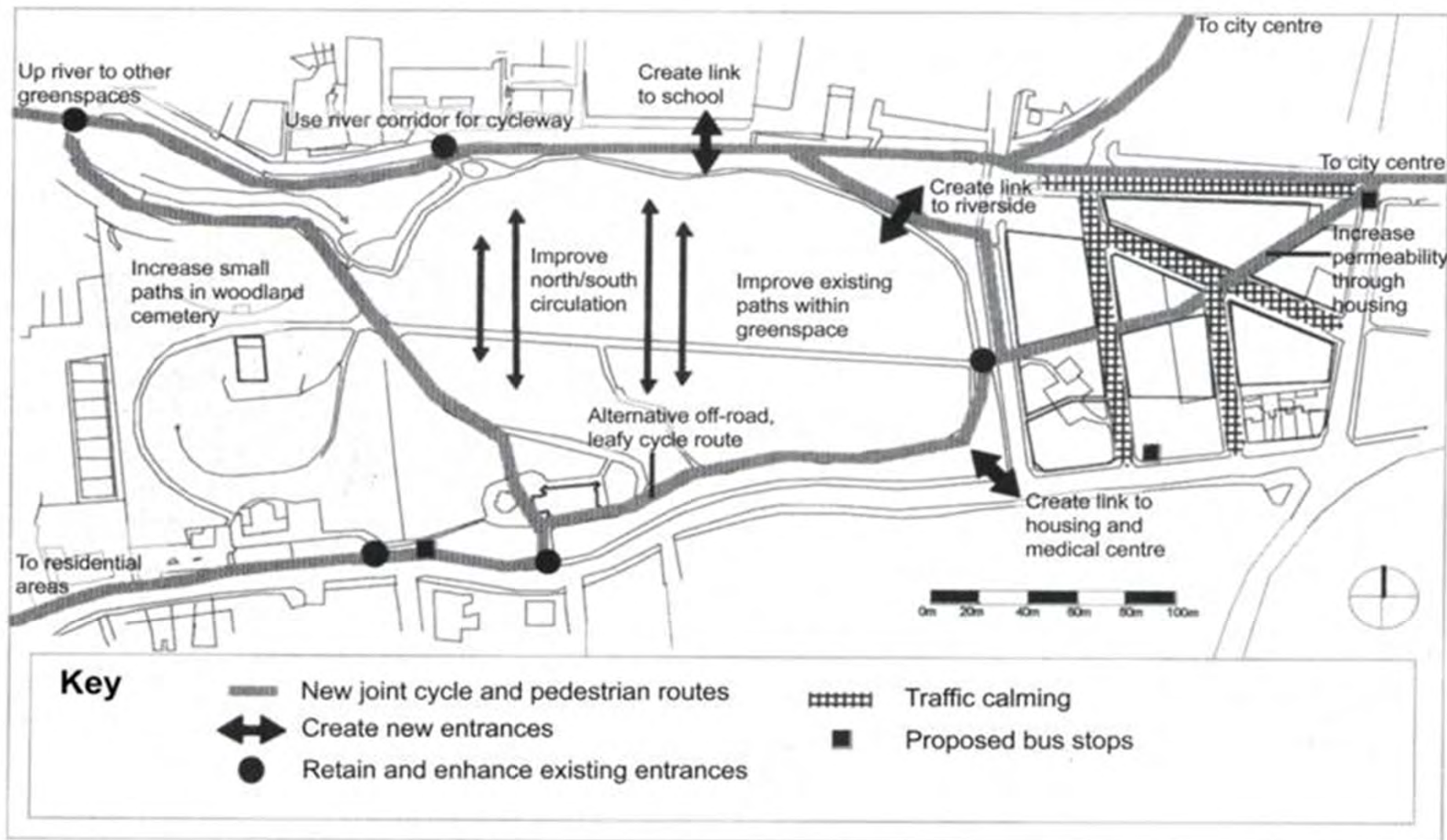

Figure 17.5 Transport strategy; access, circulation and links.

Strategija razvoja komunikacija : pristupi, cirkulacija i veze

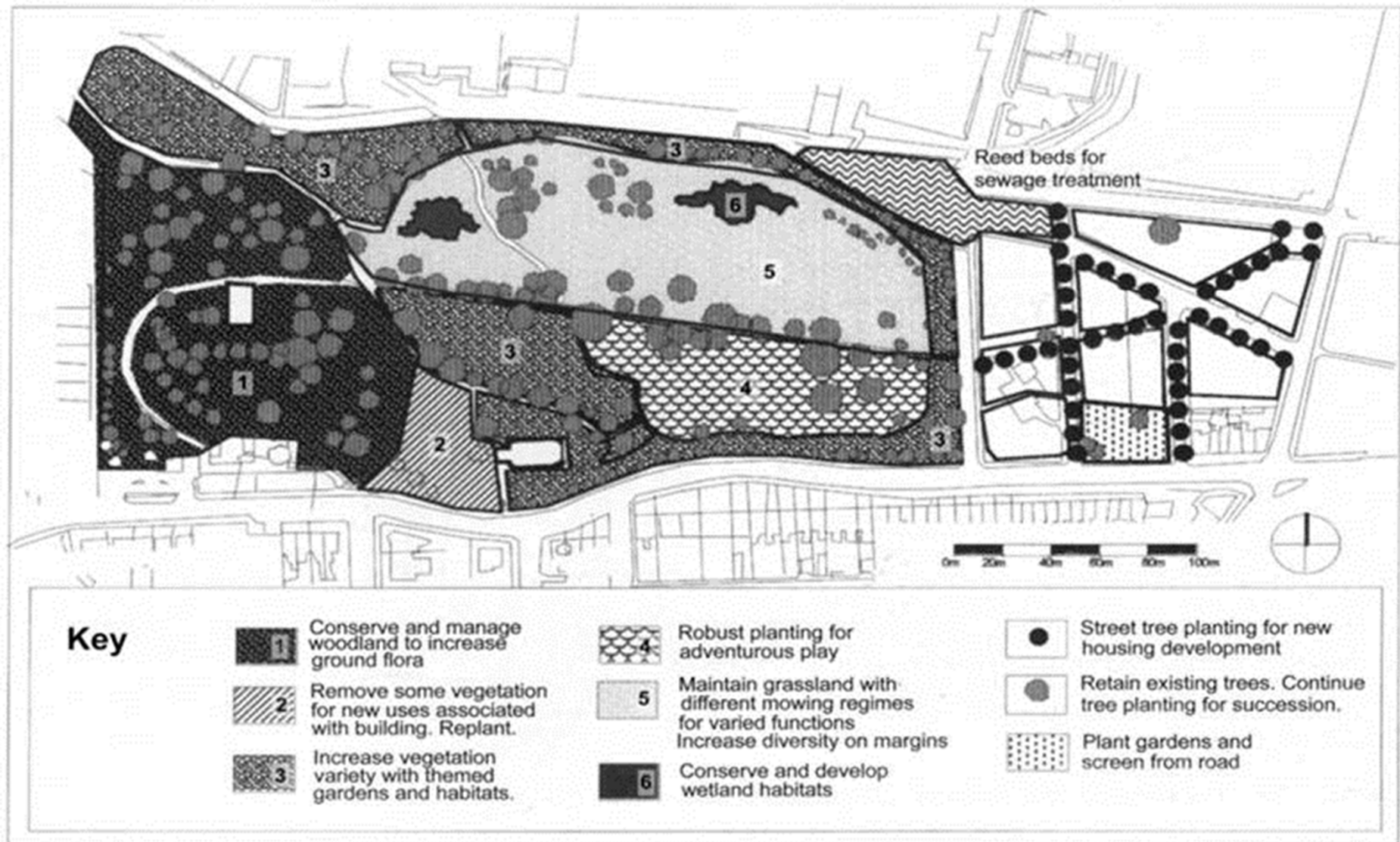

Figure 17.6 Vegetation strategy.

Strategija razvoja vegetacije

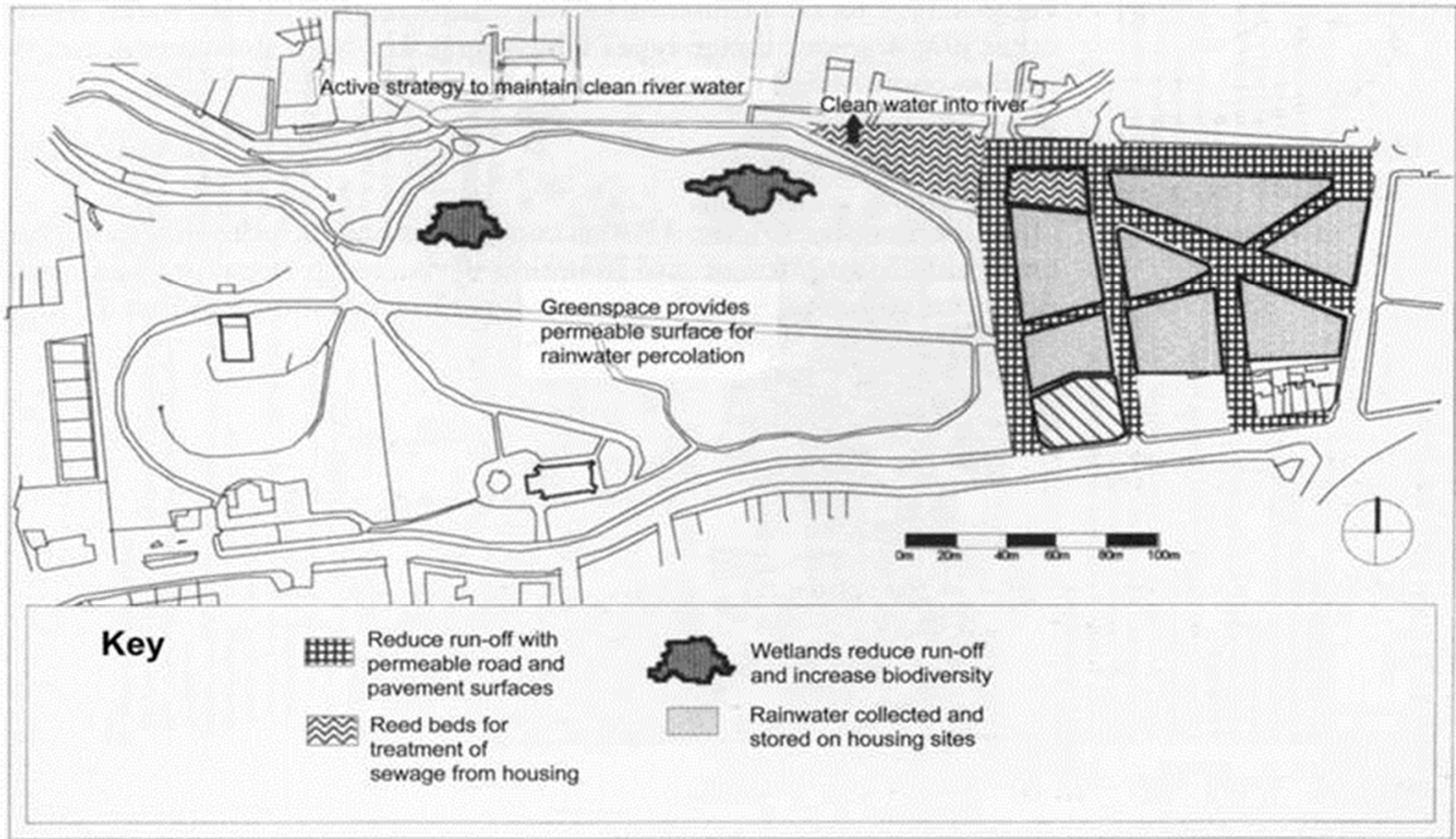

Figure 17.7 Local water management.

Upravljanje vodom

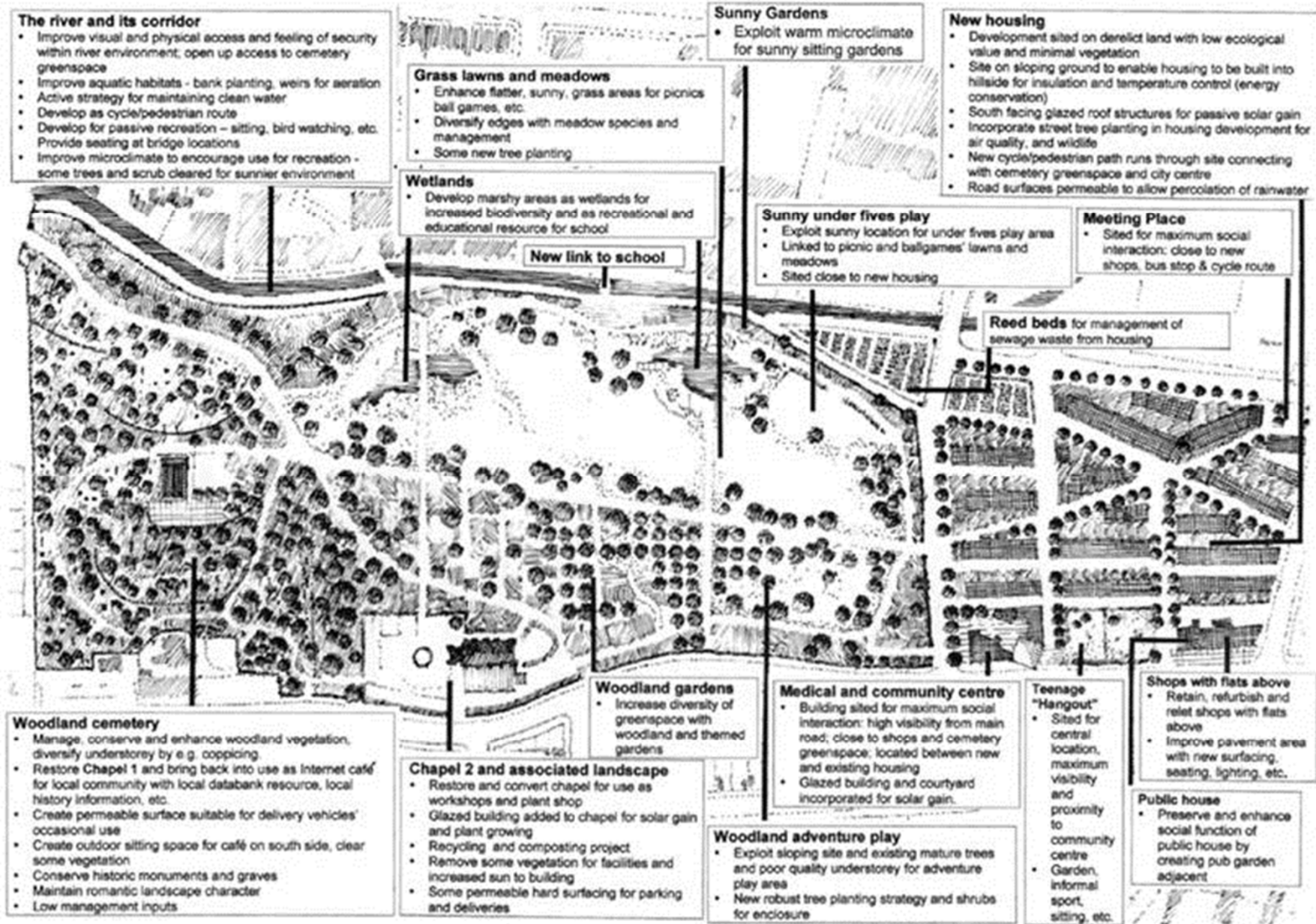

Figure 17.9 The final site plan.

Sintezni plan

