

PAVILJONI

DRUGI DEO









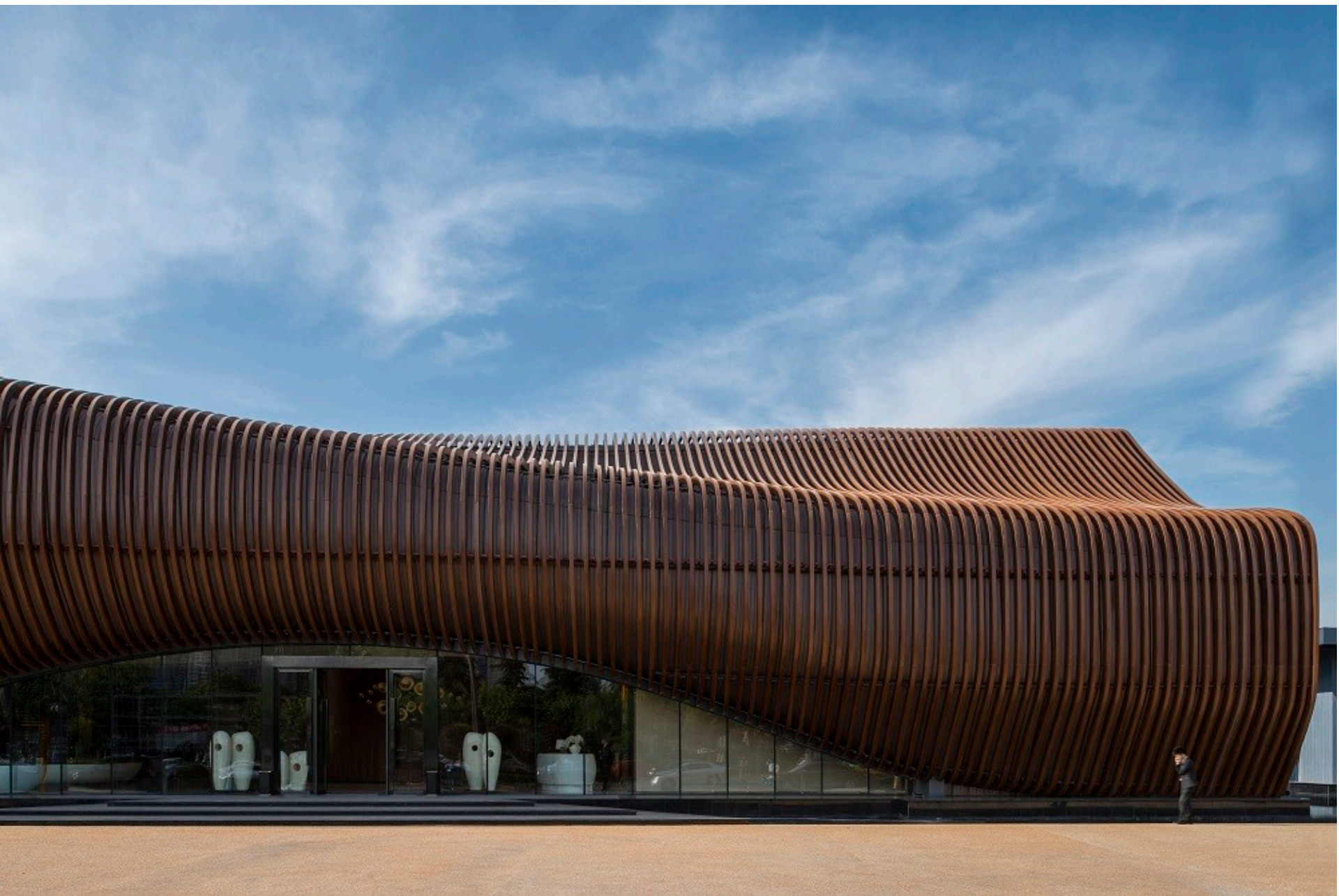



WARREN G. BENTLEY
NEW YORK UNIVERSITY

HOW
go
evils

NASA
EARTH
SPACE

ATMOSPHERE
LAND
OCEAN

THE SOUND
OF SATELLITES

GOULD











TISCH HALL

















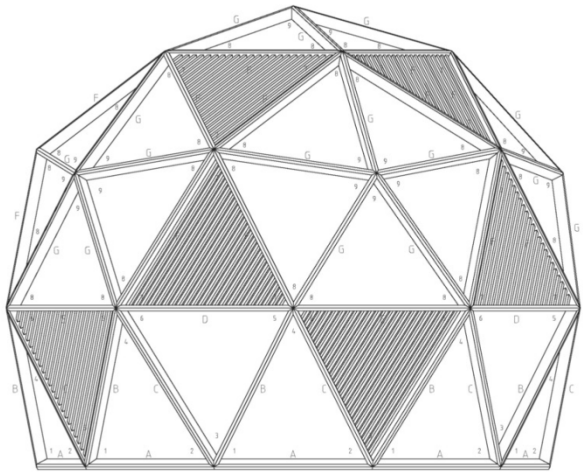

SKALA 1:200 (A1-format) (A3-format)
 0 0,5 1 1,5 2m

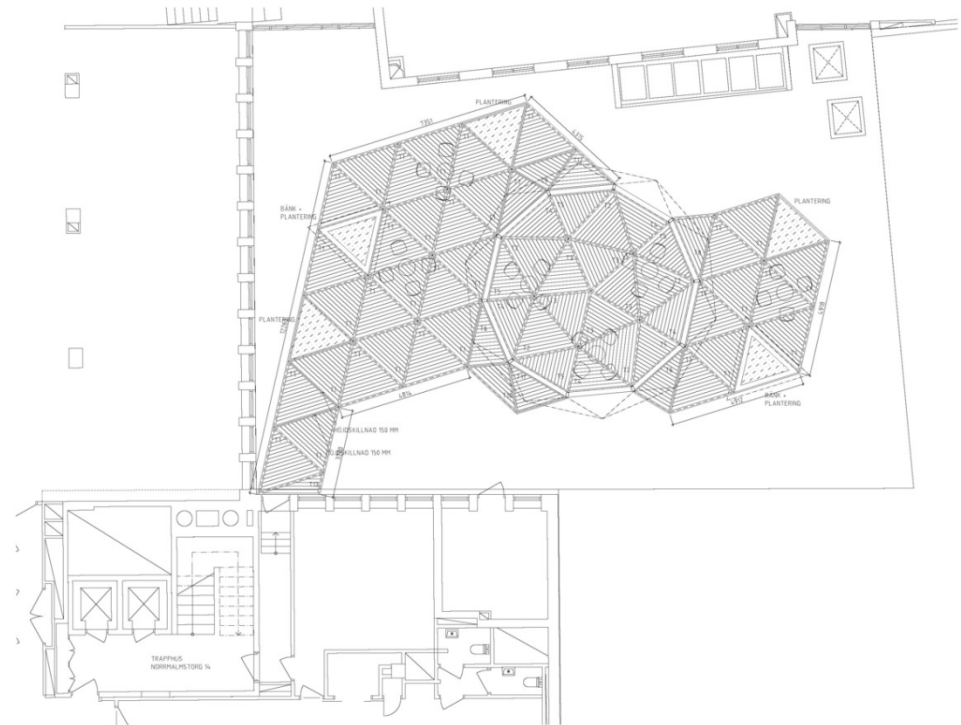

SKALA 1:50 (A1-format) (A3-format)
 0 2 4 6m











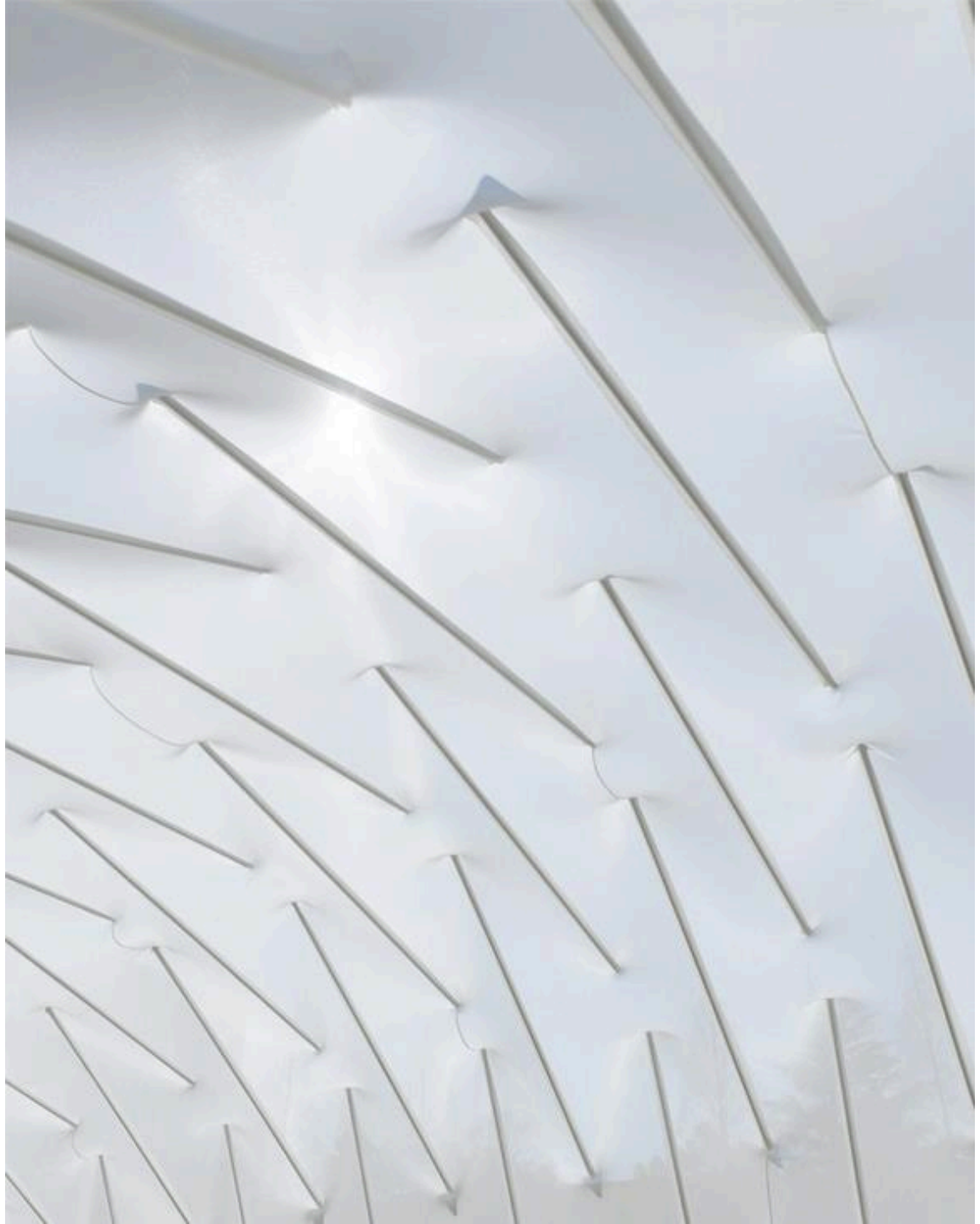













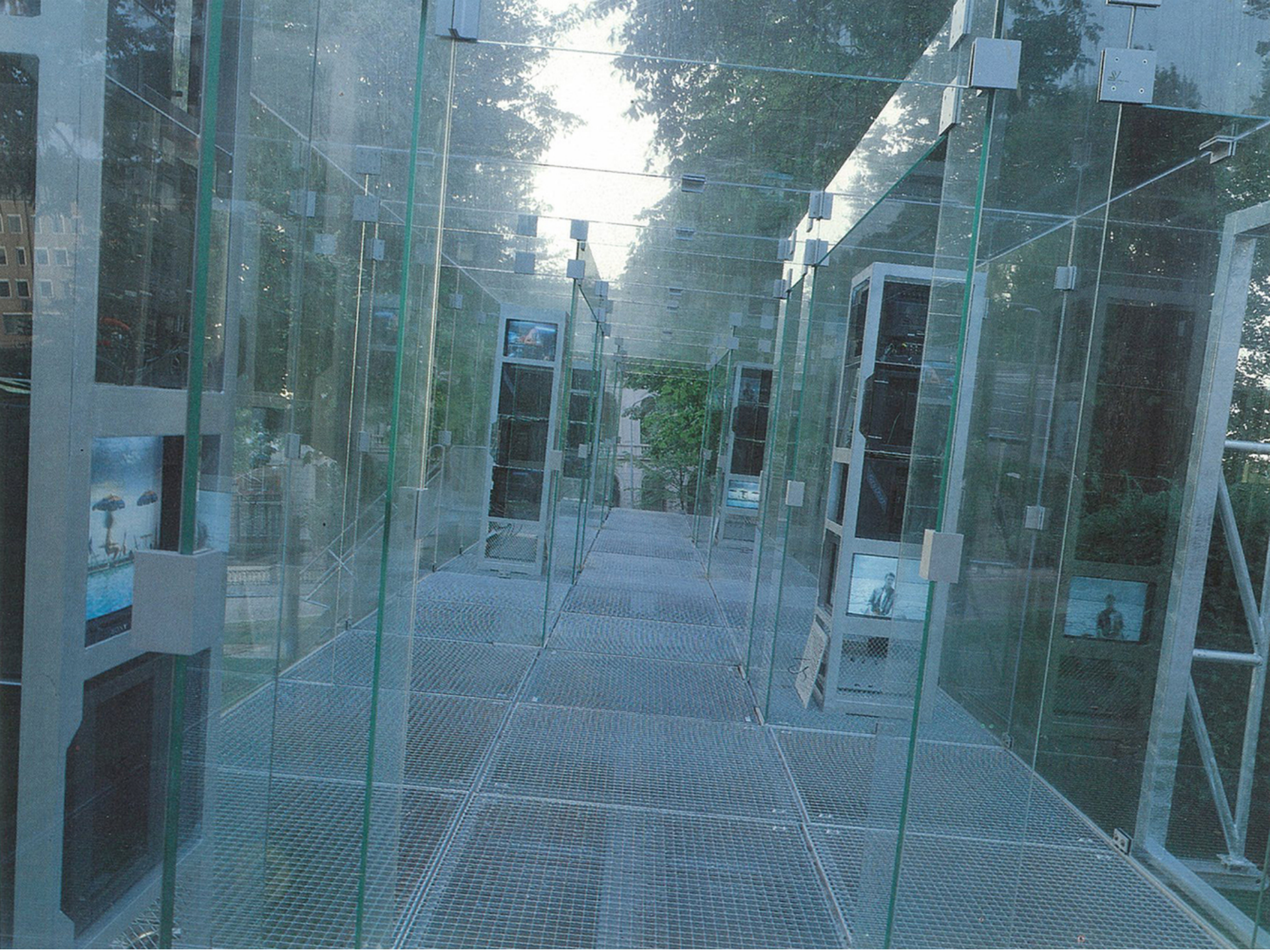









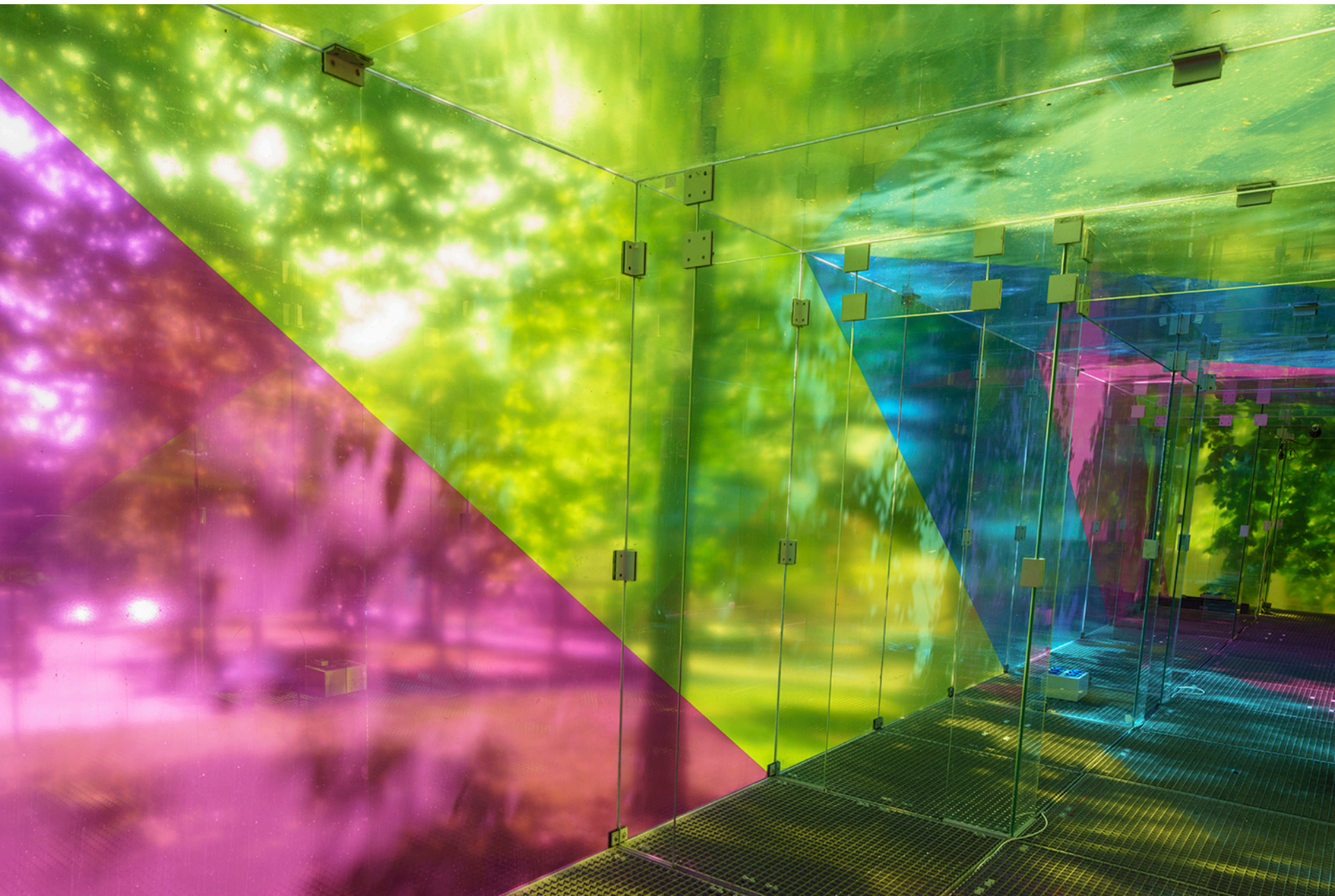









































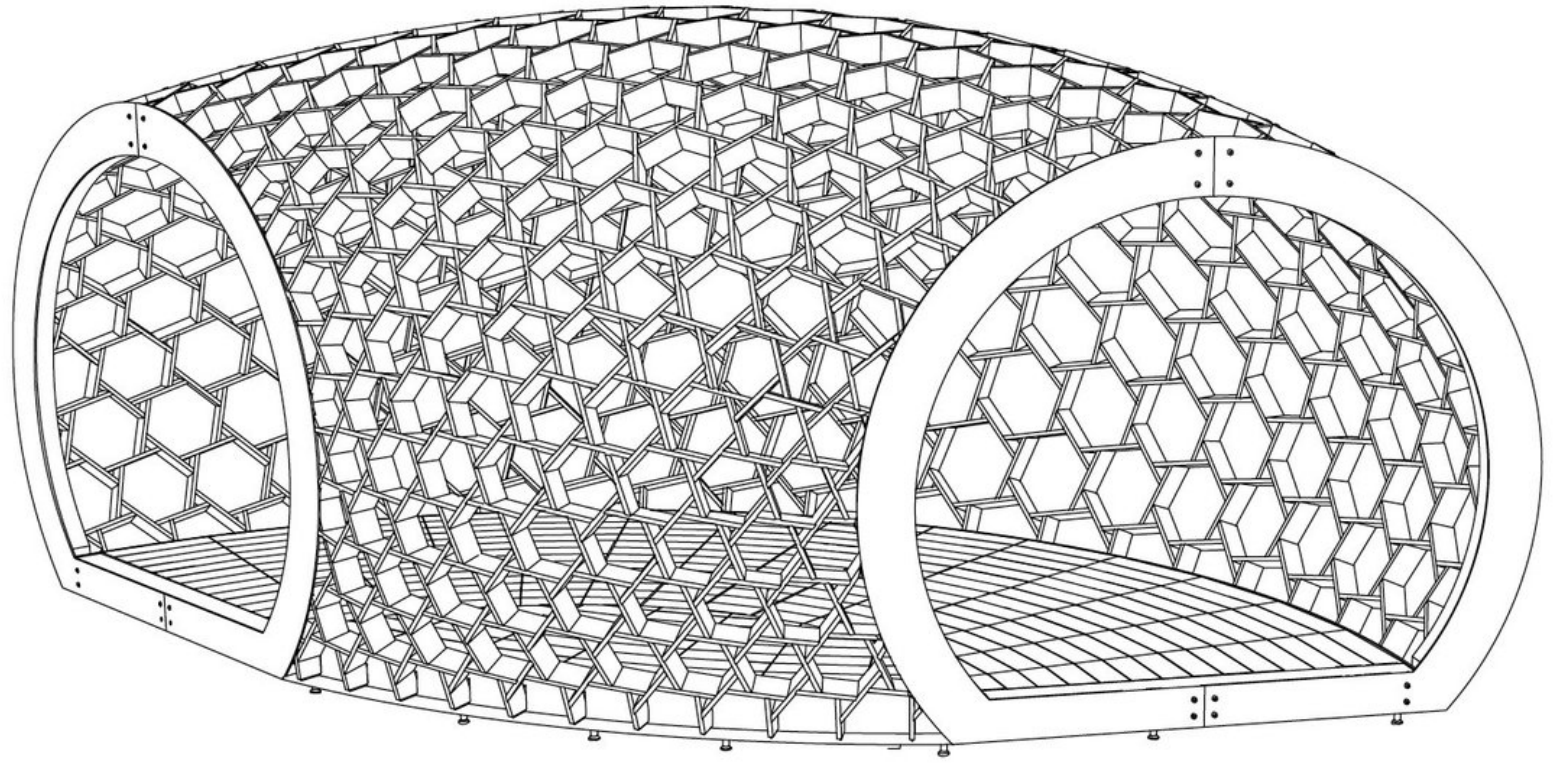

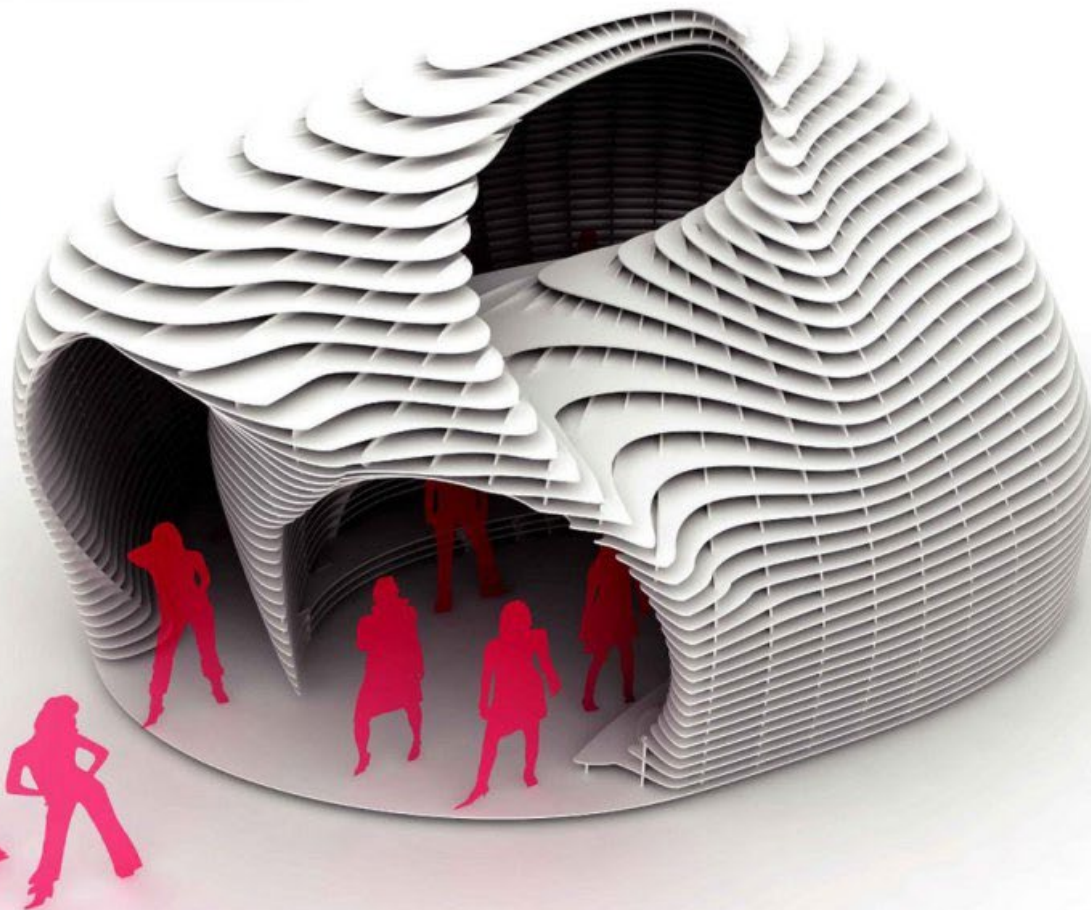
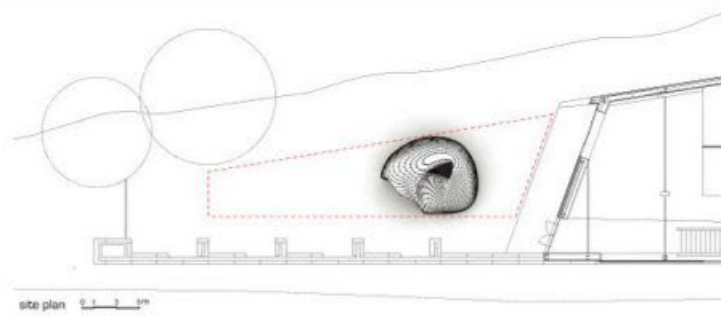
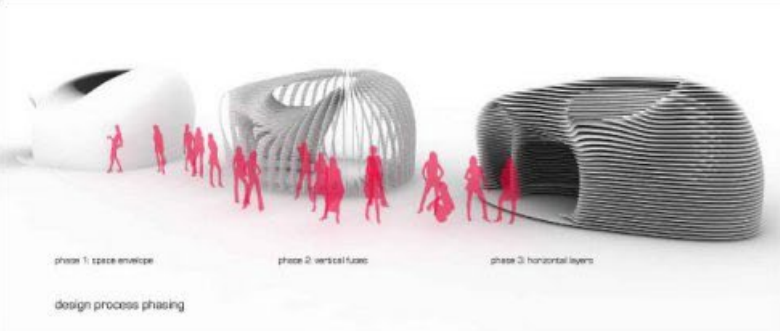

THE ART FUND PAVILION

Architecture Competition

BOARD TITLE:
**DESIGN
CONCEPT**

BOARD #:
2 / 4

COMPANY/GROUP/DESIGNER'S NAME:
Cesare Griffa, Mauro Fassino, Federico Rizzo

CONTACT NAME: Cesare Griffa

COUNTRY: Italy

EMAIL: emily@studiogriffa.net

WEBSITE: www.studiogriffa.net

TELEPHONE: +39 011 839 0000

MOBILE: +39 335 835 7621



DREAM PAVILION

through Sparkling Wings

SITE TREATMENT AND GENERATIVE PROCESS OF THE PROJECT

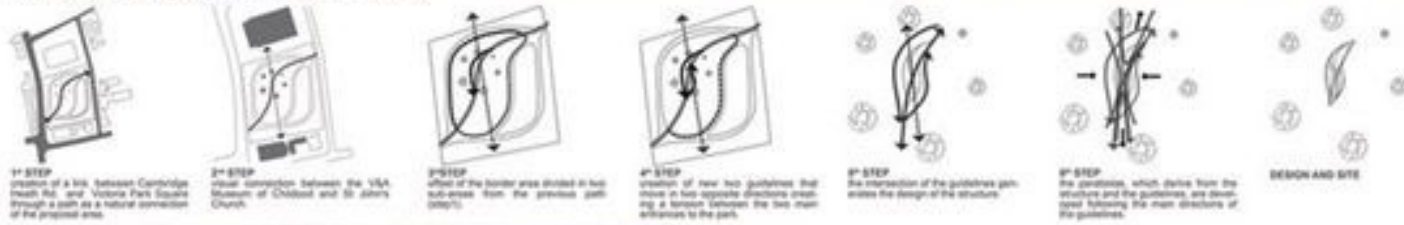

PROPOSAL
 Our dream pavilion is a place of **harmony, peace and beauty**.
 The theme is a pavilion, a protective shell, where **metamorphosis** of feelings and thoughts take place. A space that encourages imagination, where everything appears pure, charming and surprising, like the world seen through the eyes of a child.
 The separation from the environment is essential, just a light veil, like the wings of a butterfly, that establish the link between the interior and the exterior.
 The **butterfly wings** are the inspiration of the main concept. The ribbed segments are spread out all over the wings, giving brightness and change of colors with the sun movement to the pavilion. The pavilion, reacting to light, will be **ever changing** within the different weather and distances. People can walk or stay throughout the sparkling wings and think about their dreams.

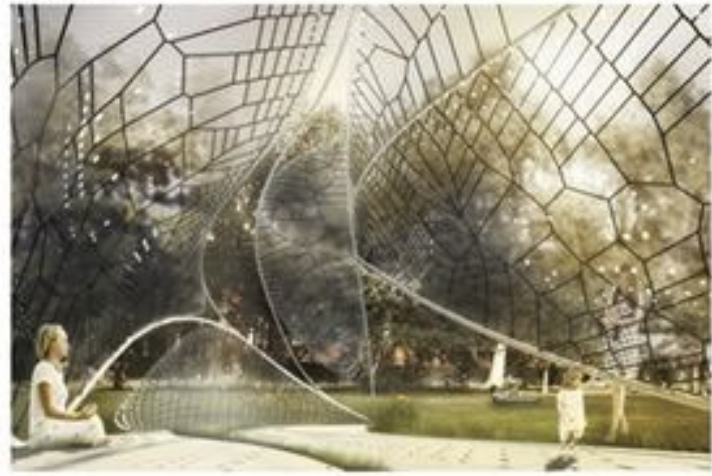

ROOF PLAN



EAST ELEVATION



SECTION A-A'



PLAN



SITE TREATMENT

The pavilion was born from a strong relationship with the context. The pavilion creates a link between Cambridge Heath Rd and Victoria Park Square through a connection that follows the natural path of the proposal area and a visual connection between the YSA Museum of Childhood and St John's Church. All the shapes of the design and its position in the park is generated from the form of the area where the pavilion is placed.

DIAGRAMS AND MATERIALS

- 1. **PLATFORM IN WOOD**
with a cutted area that allow the grass to be part of the pavilion
- 2. **MAIN STRUCTURE IN BAMBOO PAINTED WHITE**
is shaped by urban process of deformation of the landscape
- 3. **METAL GRID**
recycled metal grids which can be shaped during the working progress
- 4. **MEMBRANE IN PVC**
transparent membrane
- 5. **HOLOGRAPHIC FILM (DIFFRACTION FOLDS)**
STAMPED ON THE MEMBRANE
This foil have a strong absorption resistance and reflect the light spectrum in several colors. Here we use the same principle of diffraction present in the butterfly wings.













intelyge

POLICIA
MUNICIPAL
madrid

D M N T J A

Bazar Sub...

29















