

argentina '07



WINERY

A PLACE TO TASTE

On the edge of a wide flood plane and adjacent to the nearest source of electricity this site near the rafting company and the entrance to Condor Valley is the perfect location for a tasting room and wine making facility. The scouting of La Bodega by vintner Duncan Meyers pinpointed this site due to the natural ventilation provided by the combination of an elevated platform and a sympathetic cool wind from the east. Motivated by the diagram of a gravity fed wine process we found analogous slate rock formations on the site that allowed us to quickly formalize a our design.

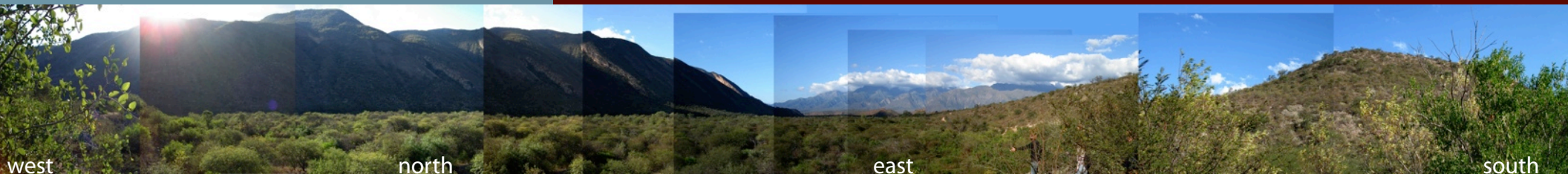

site & strata

The proposed winery site is a unique geologic feature on the bank of the river. An Island raised above the flood plane and separated from the main road by a small gully to be spanned by a low-profile bridge integrated into the winery design.

The architectural implications of the native rock is explicit.

hillside view north to site

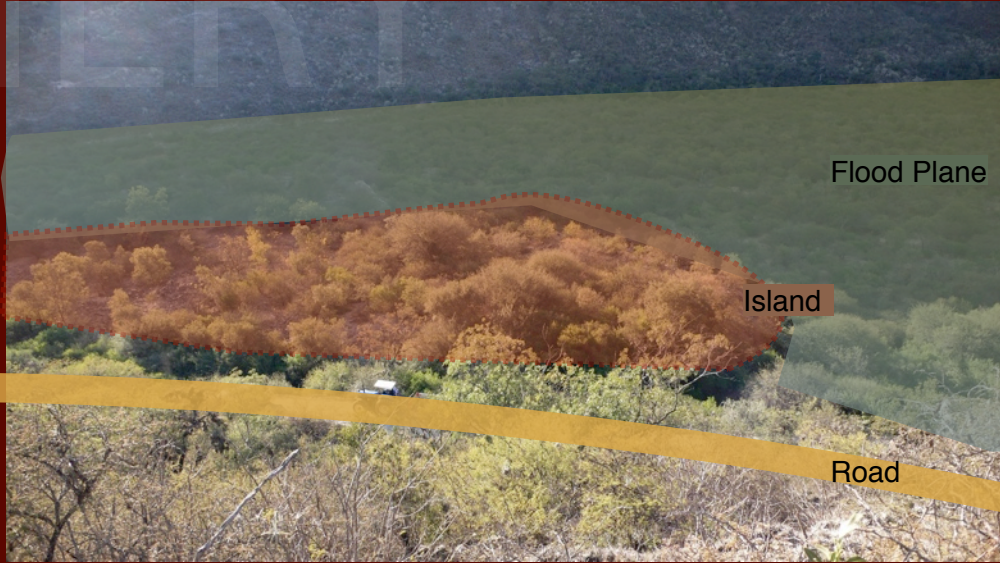

flood plane view north to site

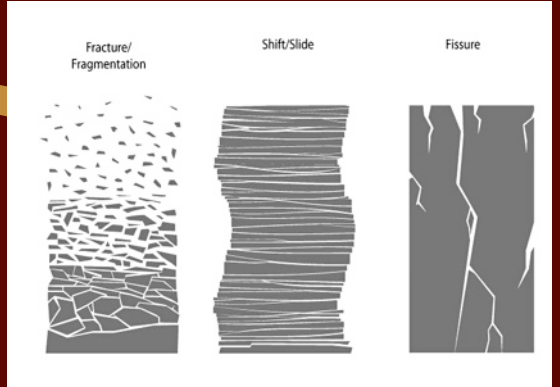

diagrams & weather

Our design uses the natural ramping of the site as virtual momentum displacing the necessary program blocks and creating a simple circulation solution for the building

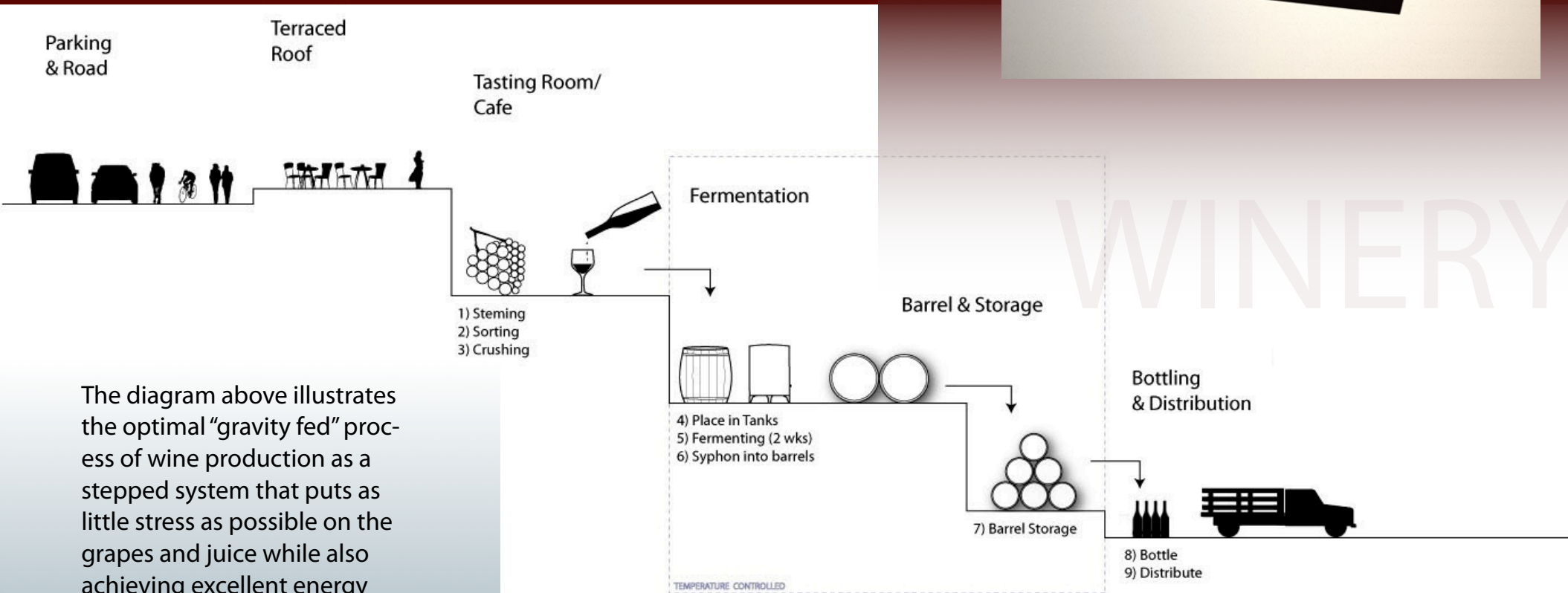
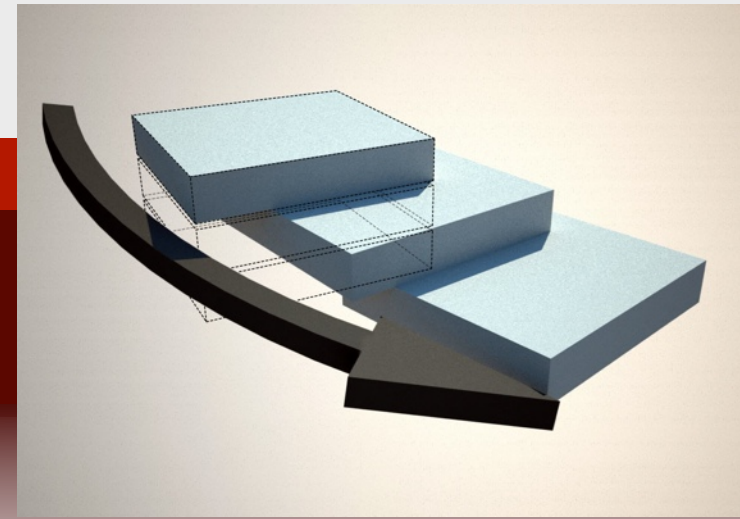

The diagram above illustrates the optimal "gravity fed" process of wine production as a stepped system that puts as little stress as possible on the grapes and juice while also achieving excellent energy efficiency.

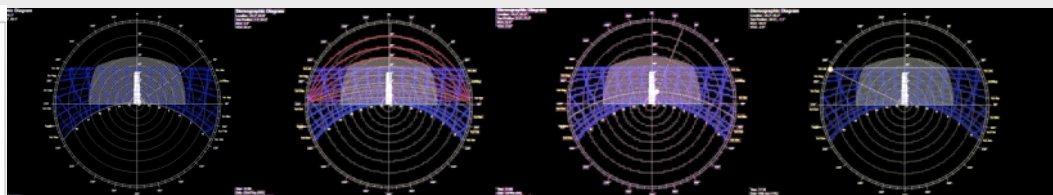
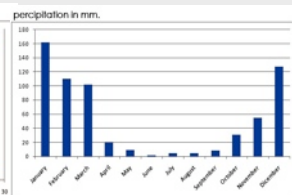
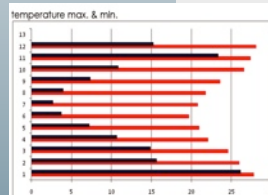

gravity fed winery

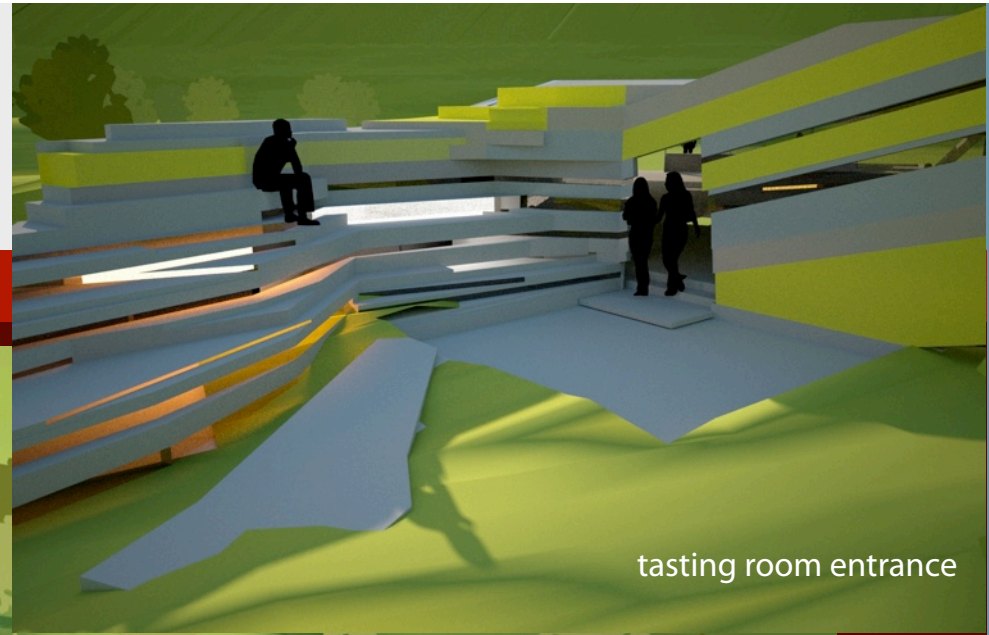

tasting room entrance



view from the north

tasting room



WINERY

plans & section

