

PRINCIPI

GRAĐENJA ARHITEKTONSKE FORME

DIHOTOMIJE

ARHITEKTONSKE FORMI

- UDVOJENE I PONOVLJENE FORME
- SUPTRAKTIVNE I ADITIVNE FORME
- SIMETRIČNE I ASIMETRIČNE FORME
- KONTRASTNE I HARMONIČNE FORME
- POLIEDARSKE, RADIJALNO-SPIRALNE I SKULPTURALNE FORME
- BIOMORFNE I EKO-FORME
- FLUIDNE I KINETIČKE FORME

UDVOJENE I PONOVLJEN FORME



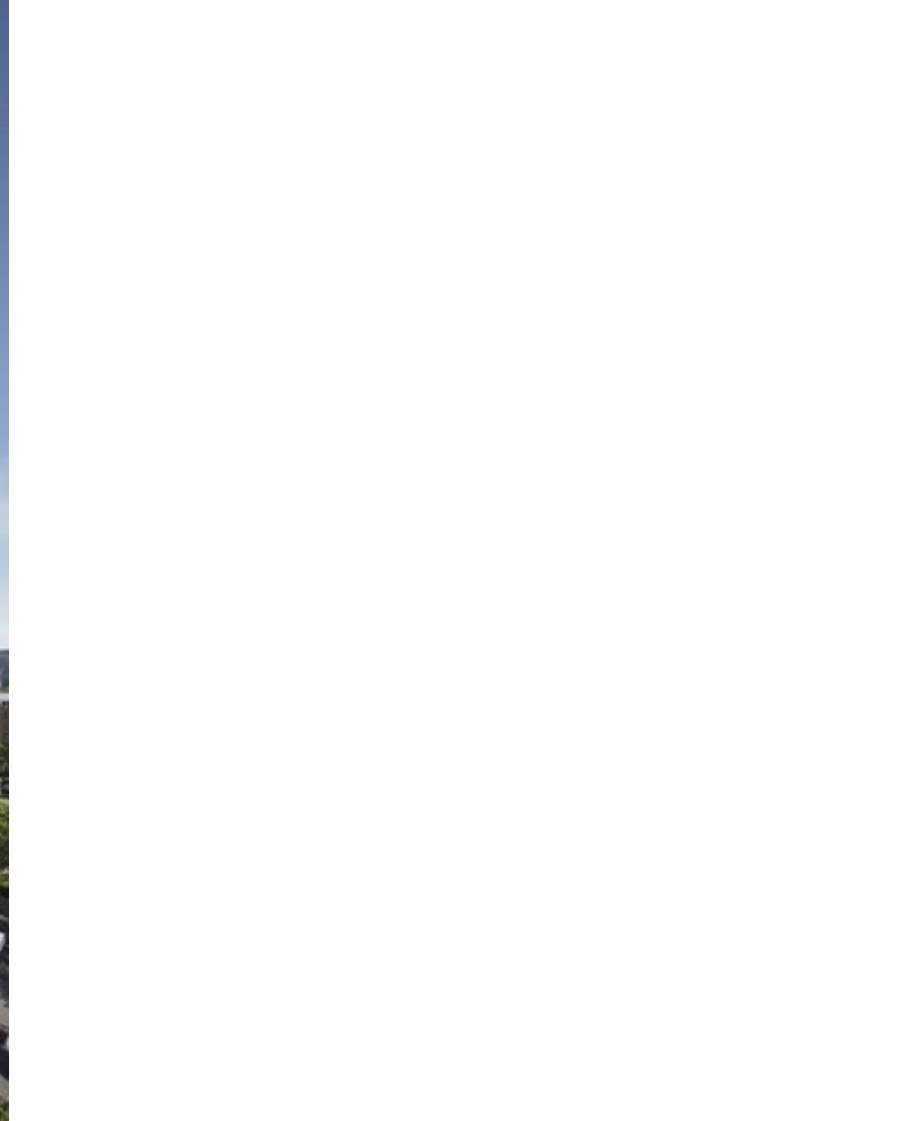







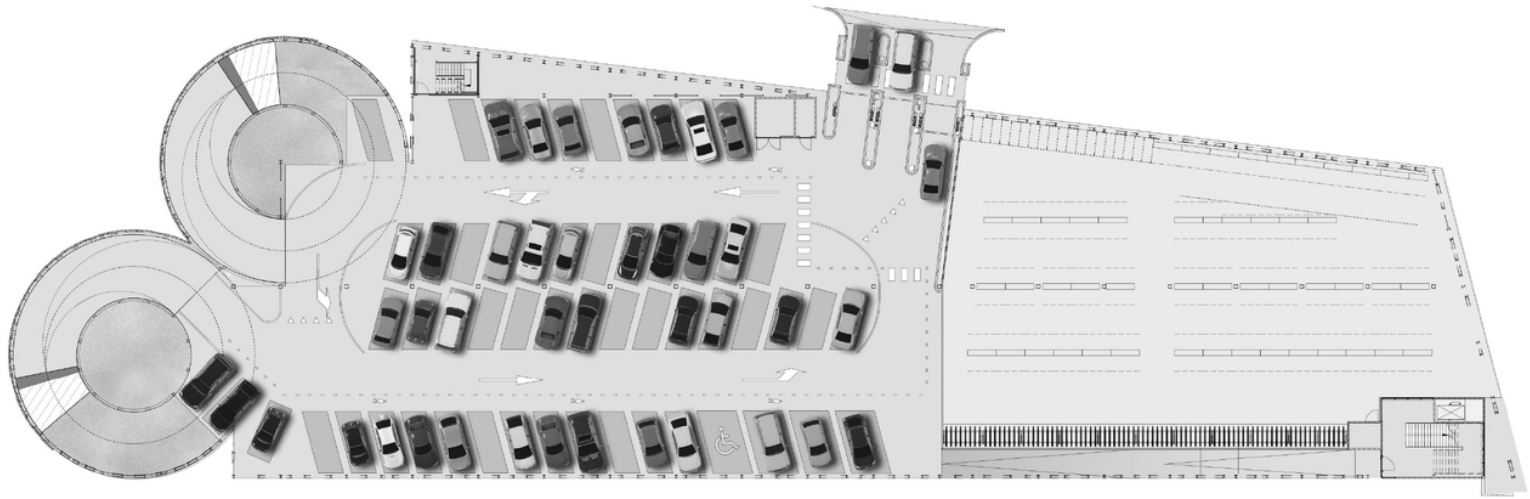







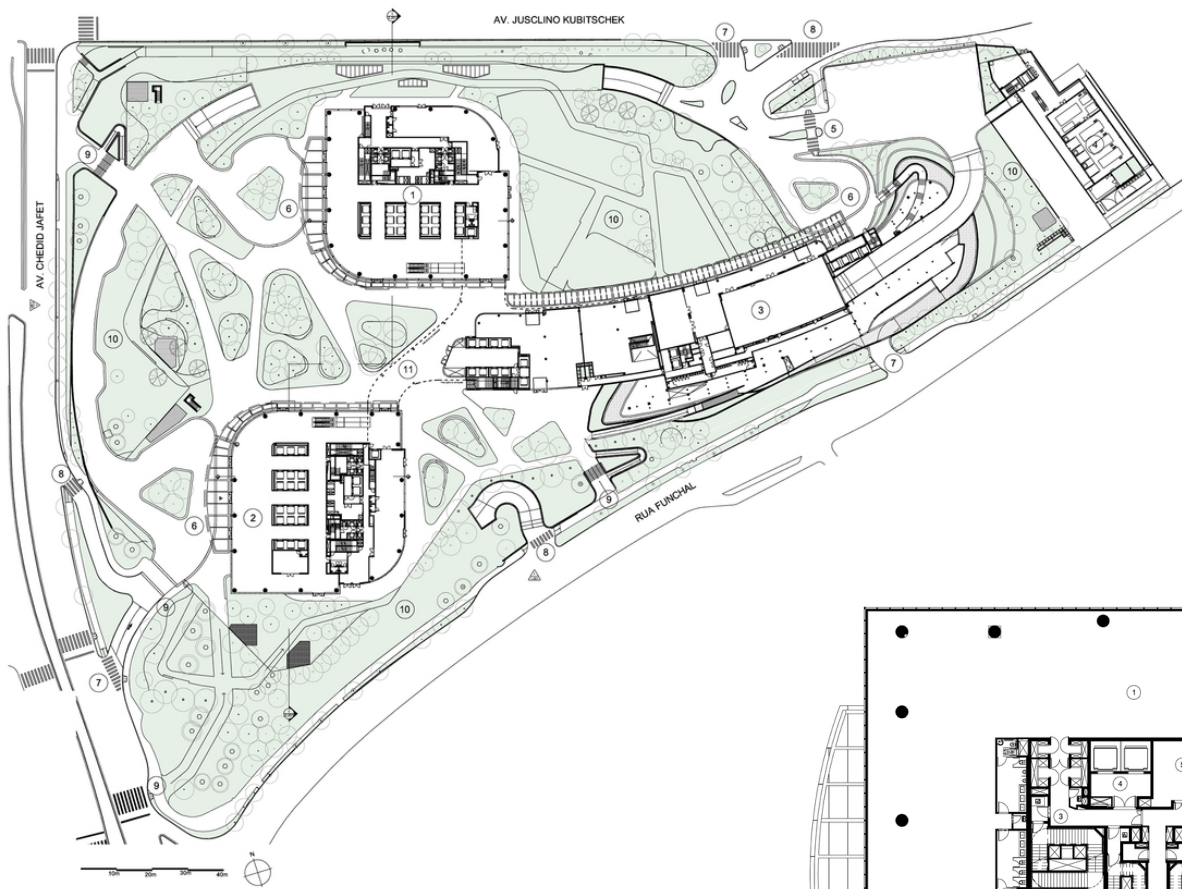

- ① SETOR 01 - TORRE A
- ② SETOR 02 - TORRE B
- ③ SETOR 03 - PRÉDIO AMENITY
- ④ SETOR 04 - PRÉDIO TÉCNICO
- ⑤ ACESSO SERVIÇOS
- ⑥ PORTE COCHERE
- ⑦ ACESSO VEÍCULOS
- ⑧ SAÍDA VEÍCULOS
- ⑨ ACESSO PEDESTRE
- ⑩ ÁREAS VERDES
- ⑪ MARQUISE - PRÉDIO AMENITY

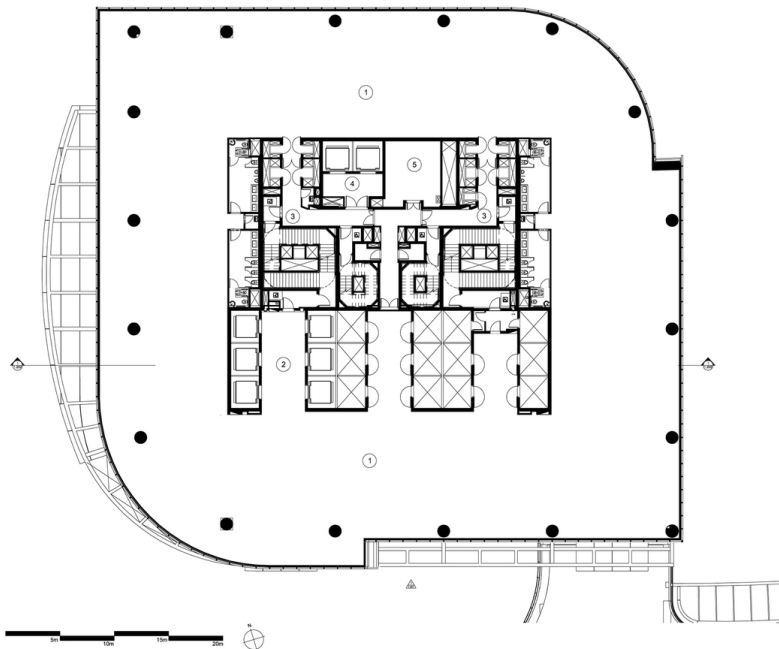

- ① ESCRITÓRIO
- ② HALL DE ELEVADORES
- ③ CIRCULAÇÃO SERVIÇO
- ④ HALL DE ELEVADORES SERVIÇOS
- ⑤ ÁREA TÉCNICA











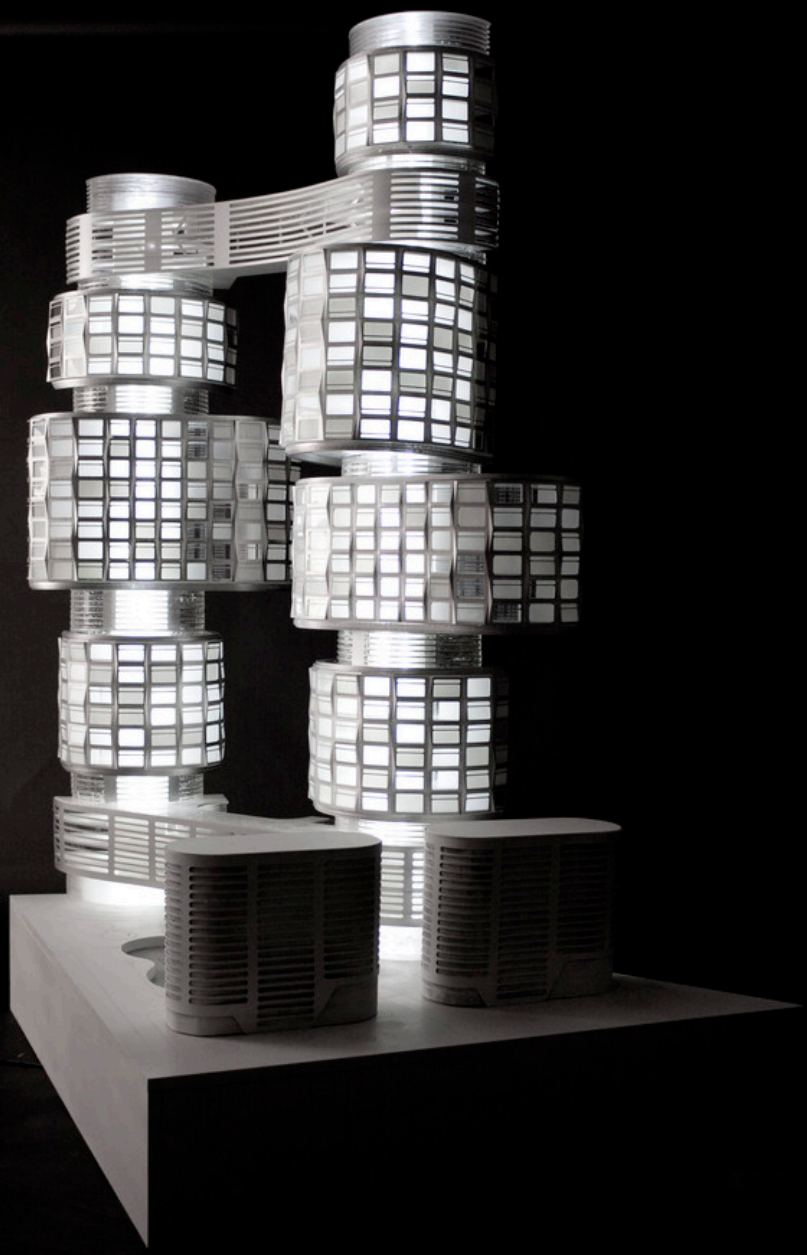

Siamese Towers / Alejandro Aravena,
Santiago, Chile, 2003

























SUPTRAKTIVNE I ADITIVNE FORME

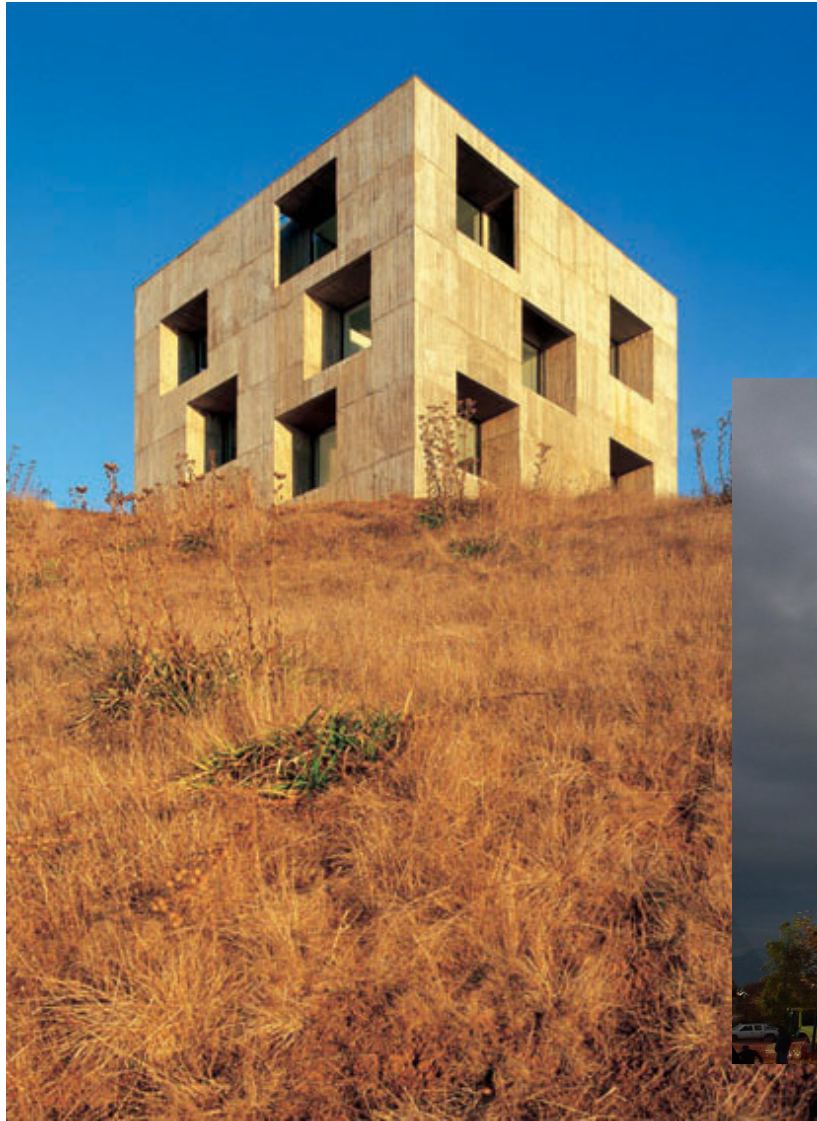





Opus building New Office Building and Hotel by Zaha Hadid Architects, Dubai, 2017





210,000 | 90,000 | 132 |
OMNIA | 800 666



Morpheus Hotel Zaha Hadid Architects, COTAI, MACAO (SAR), 2018



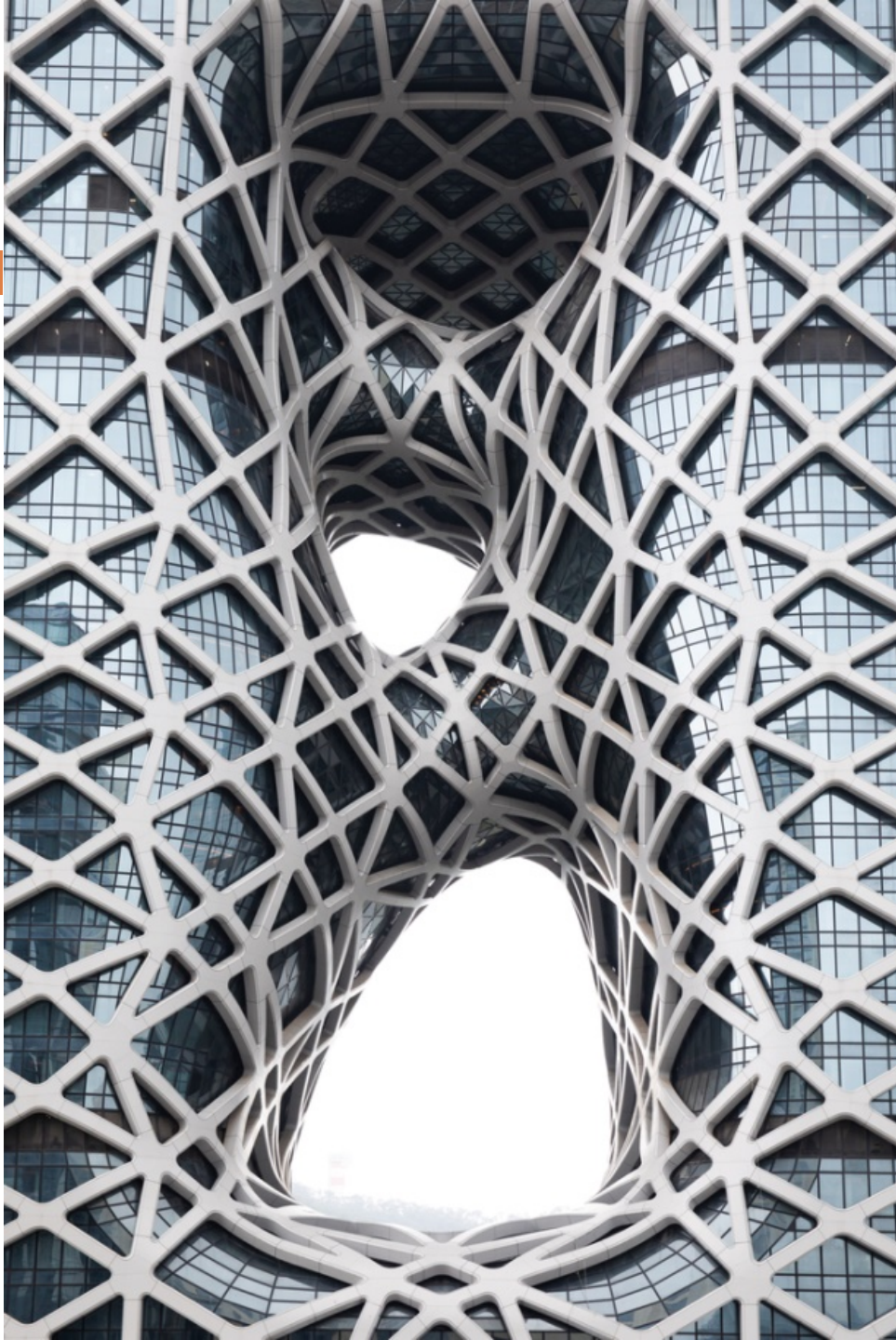

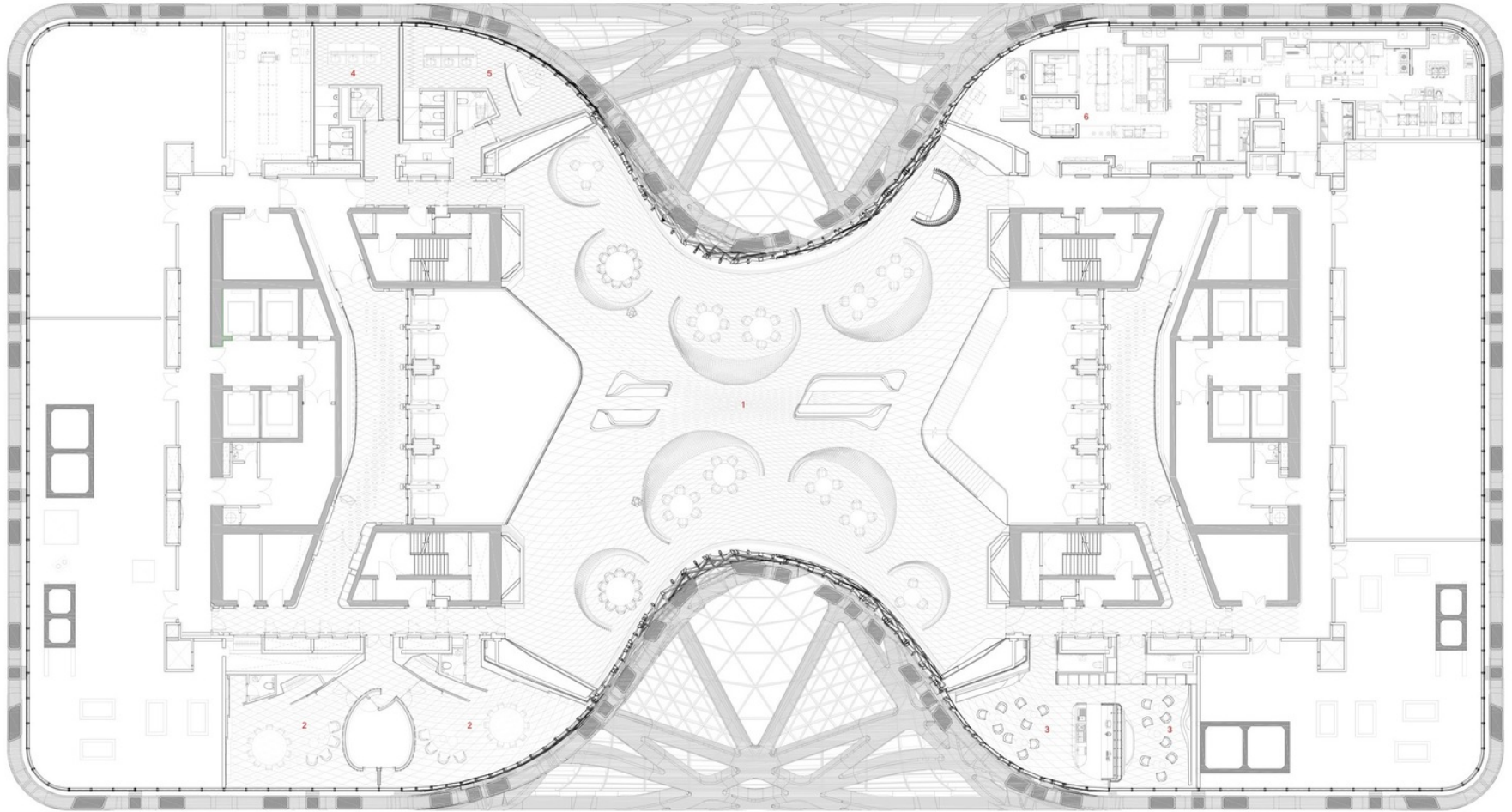

1 MAIN RESTAURANT
2 PRIVATE DINING ROOMS
3 PRIVATE CLUB

4 MALE RESTROOM
5 FEMALE RESTROOM
6 KITCHEN











